

6th Street Connector Improvements

June 21, 2017

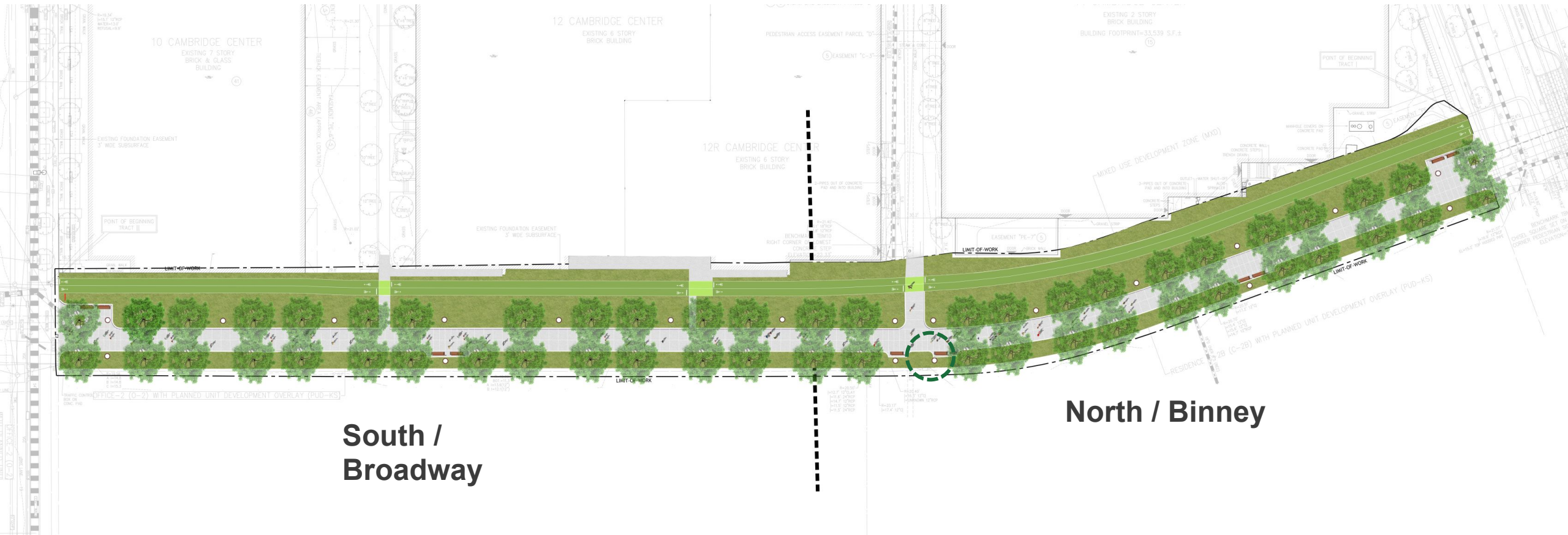

6th Street Connector Plan



**South /
Broadway**

North / Binney

6th Street Connector Plan – South / Broadway

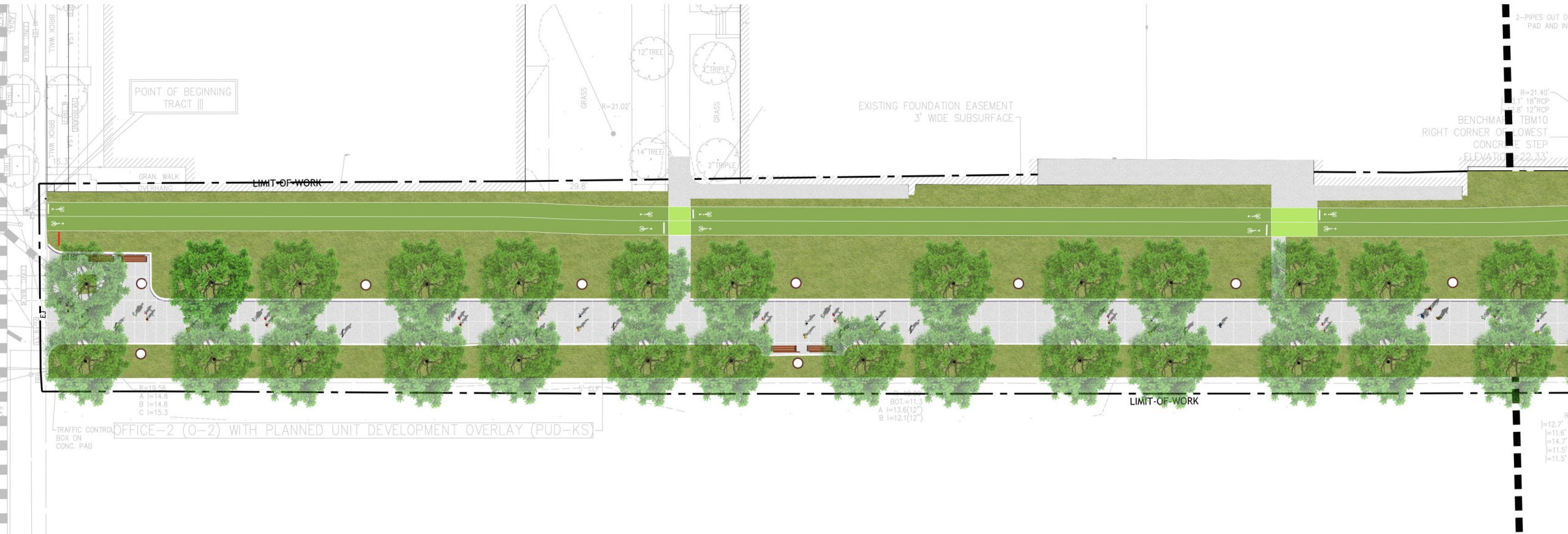

6th Street Connector Plan – Technical Sections

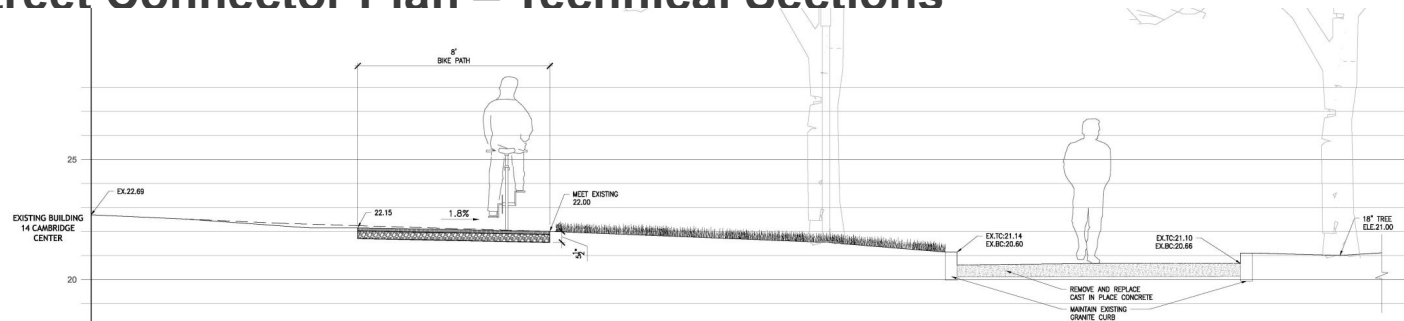

4 SECTION D-D'
SCALE: 1/2"=1'-0"

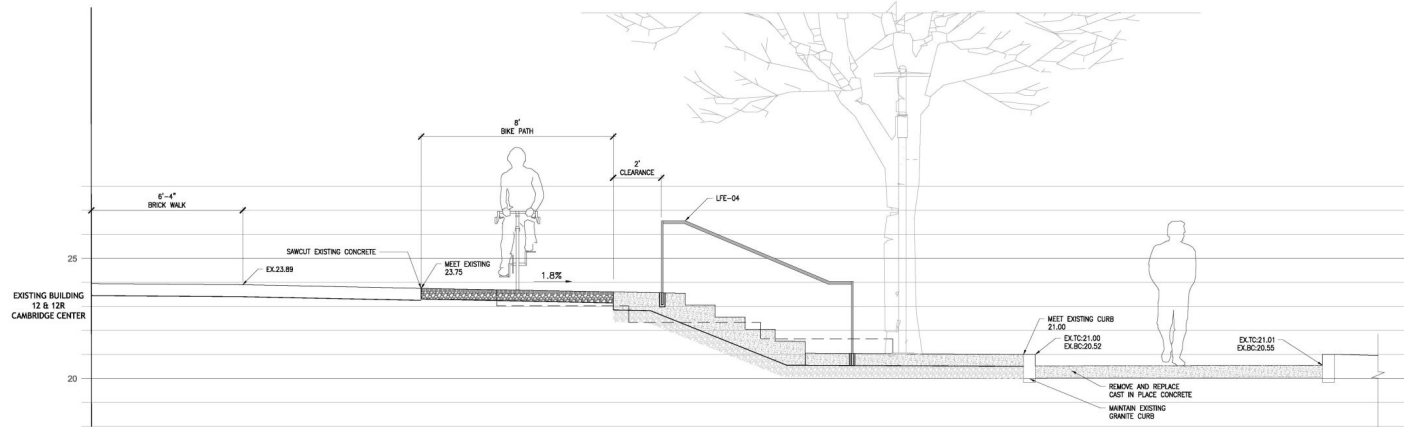

3 SECTION C-C'
SCALE: 1/2"=1'-0"

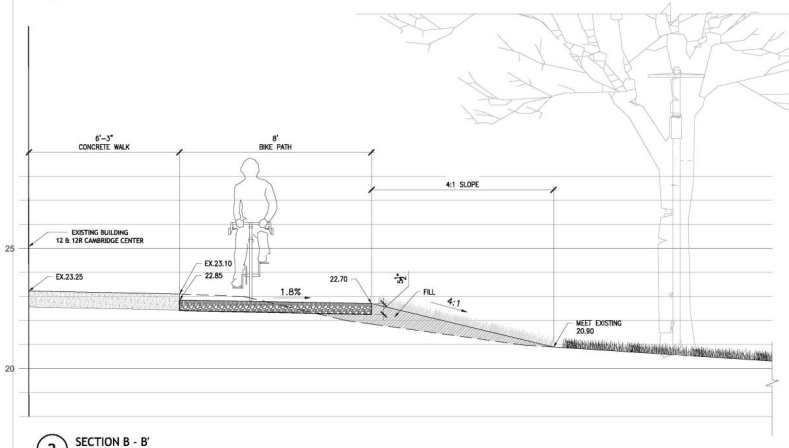

2 SECTION B - B'
SCALE: 1/2"=1'-0"

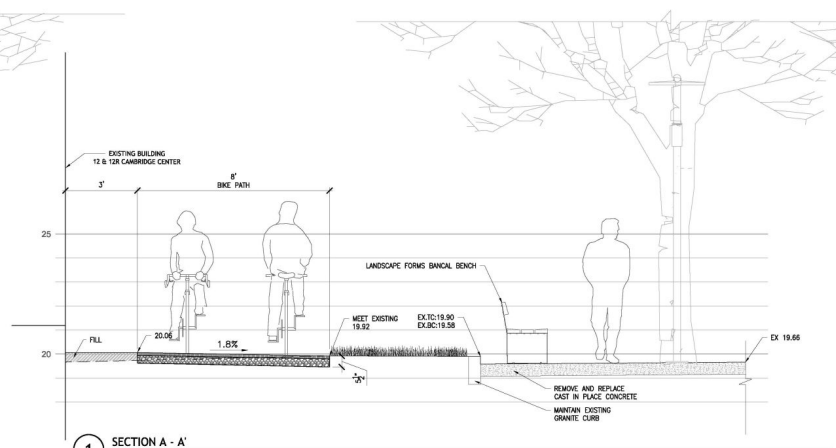

1 SECTION A - A'
SCALE: 1/2"=1'-0"

6th Street Connector Seating - Bancal Bench

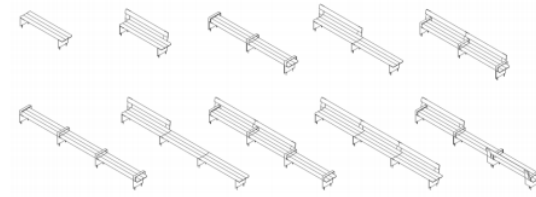

Bench options

Included components:

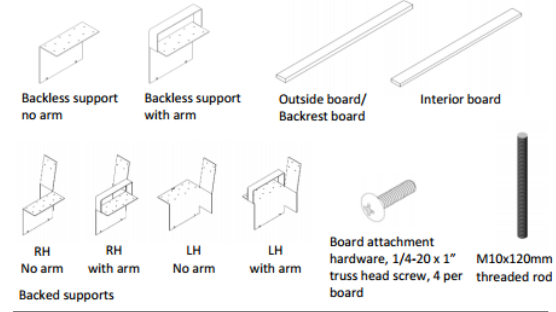

Tools required:

- #3 Phillips screwdriver
- For anchor holes: $\varnothing 7/16$ " drill
- Chemical anchoring adhesive, if specified
- Proper personnel for lifting bench

ASSEMBLE WITH CARE! Pangard II® Polyester Powdercoat is a strong, long-lasting finish. To protect this finish during assembly, place unwrapped powdercoated parts on packaging foam or other non-marring surface. Do not place or slide powdercoated parts on concrete or other hard or textured surface – this will damage the finish causing rust to occur. Use touch-up paint on any gouges in the finish caused by assembly tools.

landscapeforms®

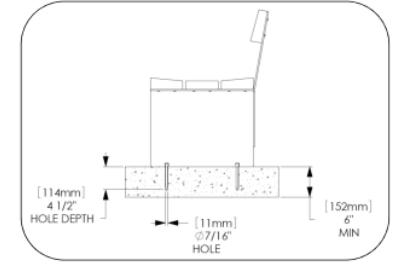

Fig. 1 – Drilled hole size, board orientation

INSTALLATION PROCEDURE:

Note: Interior seat boards are rectangular. Remaining boards are wedge-shaped. Seat boards and backrest boards may be different lengths. Refer to Fig. 8 for proper location of boards, depending on bench length. Backed supports are stamped "RH" for right-hand and "LH" for left-hand. Verify proper orientation before drilling holes.

1. Drill holes as shown in Fig. 2 as required per specified bench. Clear holes of debris.
2. Install threaded rods into supports.
3. Position first two supports so threaded rods drop into the drilled holes as shown in Fig. 4. Refer to Fig 8 for support placement for different bench styles.
4. Fasten seat boards and back board (if specified) as shown in Fig. 1, using board attachment hardware as shown in Fig. 3. Leave screws slightly loose until entire bench has been assembled.
5. Set next support in position and attach boards.
6. Tighten all screws and remove any burrs from screw heads.

For optional anchoring adhesive installation:

1. Follow steps 1 and 2 above.
2. Position first two supports as close to the drilled holes as possible without blocking access for dispensing adhesive. Refer to Fig 8 for support placement for different bench styles.
3. Follow steps 4 and 5 above.
4. Clean the drilled holes according to adhesive manufacturer's instructions.
5. Dispense adhesive into the holes, filling from the bottom to 2-1/2" from the top.
6. Using proper personnel, move the bench into position. Adhesive should rise to the top of the hole. Wipe away excess adhesive from supports.
7. Tighten all screws and remove any burrs from screw heads.

6th Street Connector Seating – Trash / Litter Receptacle



6th Street Connector Seating - Bancal Bench

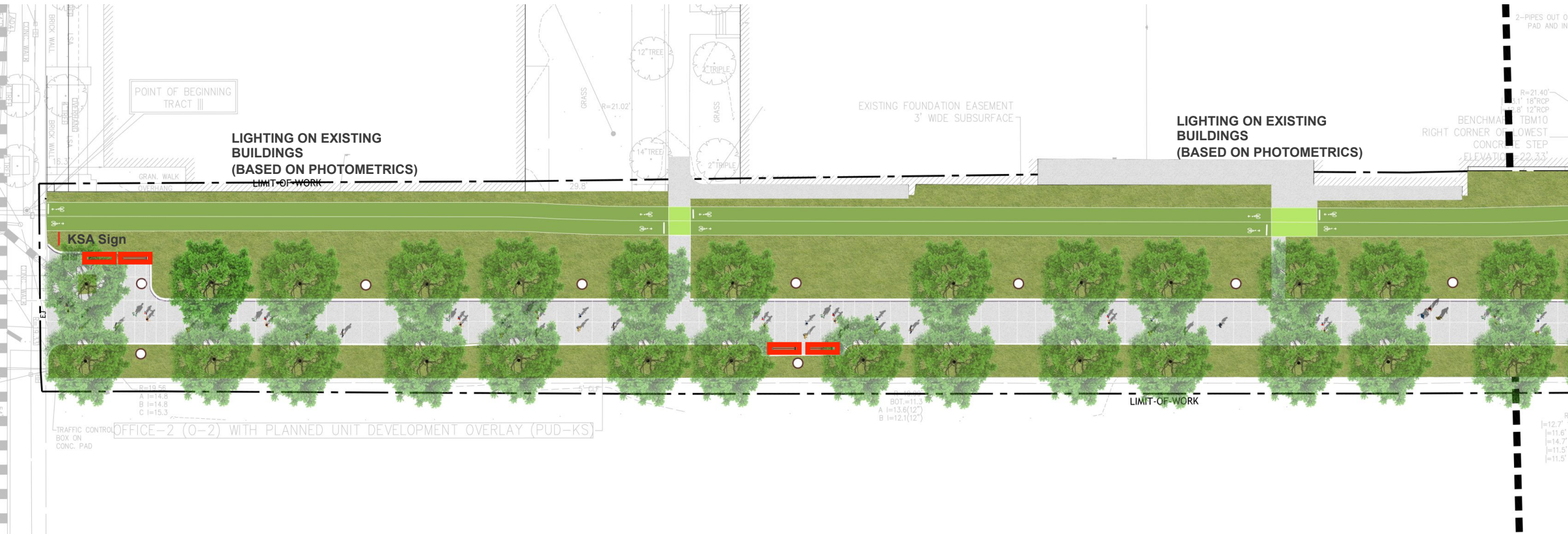

6th Street Connector Seating - Bancal Bench

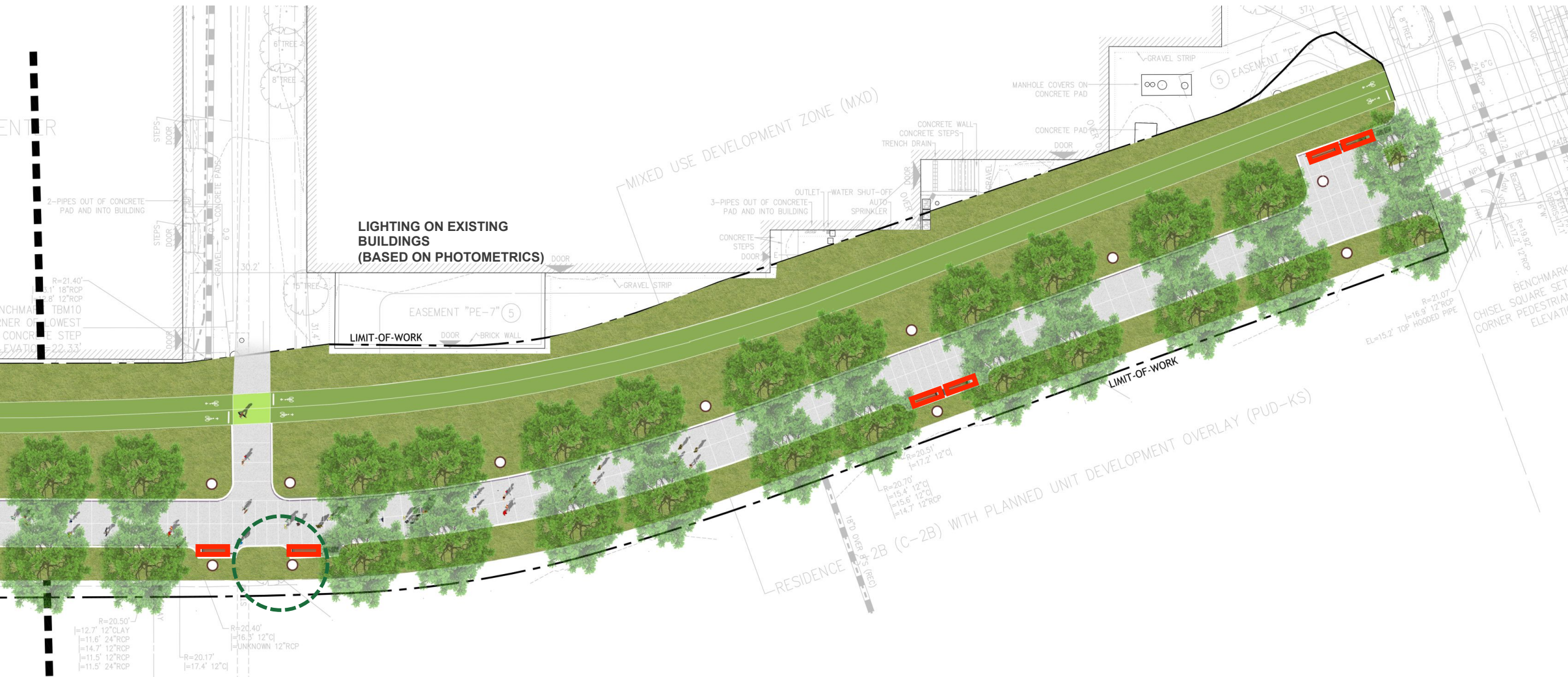

Lighting – Cree Edge (Cambridge Standard

Submitted by Omni-Lite	Catalog Number: ARE-EDR-5S-R3-04-E-UL-BK-350-35K-DIM-SOLITELENS	Type: C - BLACK
Job Name: City of Cambridge	Notes:	OMN115-36715

ARE-EDR-5S-R3

Cree Edge™ Round Area Luminaire – Type V Short – Spider Mount, Center Tenon

Product Description

Slim, low profile design minimizes wind load requirements. Luminaire sides are rugged cast aluminum with integral, weathertight LED driver compartments, spun vented cover and high performance aluminum heat sinks. Post top mounting consists of four precision machined, extruded aluminum arms mounted to weathertight cast lower hub with center tenon adaptor and is designed to slip-fit over a 2.375" (60mm) IP to 3" (76mm) O.D. steel or aluminum tenon or pole and secures to tenon with four set screws.

Performance Summary

Utilizes BetaLED® Technology

Patented NanoOptic® Product Technology

Made in the U.S.A. of U.S. and imported parts

CRI: Minimum 70 CRI

CCT: 5700K (+ / - 500K) Standard, 4000K (+ / - 300K)

Limited Warranty*: 10 years on luminaire / 10 years on Colorfast DeltaGuard® finish

EPA and Weight: Reference EPA and Weight spec sheet

Accessories

Field Installed Accessories

XA-BRDSPK
Bird Spikes

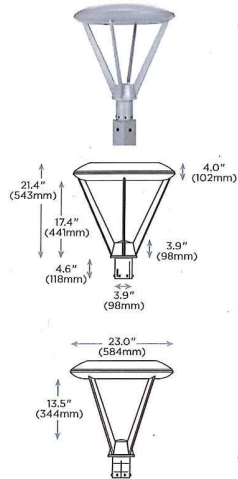

Ordering Information

Example: ARE-EDR-5S-R3-04-E-UL-SV-350-OPTIONS

ARE-EDR	SS	R3	04	E	UL	BK	350	35K-DIM - SOLITE LENS
Product	Optic	Mounting	LED Count (x10)	Series	Voltage	Color Options	Drive Current	Options
ARE-EDR	SS Type V Short	R3 Spider Mount, Center Tenon	04 08 08 10* 12	E	UL Universal 100-277V ULI Universal 347-480V 34 347V 12 120V 27 277V	SV Silver (Standard) BK Black BZ Bronze PB Platinum/Bronze WH White	350* 350mA 325 525mA 700 700mA	40K 4000K Color Temperature Color temperature per luminaire DIM 0-10V Dimming - Control by others - Refer to dimming spec sheet for details - Can't exceed specified drive current F Fuse - Not available with all ML options. Refer to ML spec sheet for availability with ML options - Not available with LH or 34 voltages HL HL / Low (75 / 350 / 525 Dual Circuit Input) - Refer to ML spec sheet for details - Sensor not included P Photocell - Not available with all ML options. Refer to ML spec sheet for availability with ML options - Must specify voltage other than LH TL Two-Level (75 / 525 w/ Integrated Sensor Control)*** - Refer to ML spec sheet for details TL2 Two-Level (0 / 350 w/ Integrated Sensor Control)*** - Refer to ML spec sheet for details TL3 Two-Level (0 / 525 w/ Integrated Sensor Control)*** - Refer to ML spec sheet for details

* See www.cree.com/lighting/products/warranty for warranty terms

** Consists of multiple 120 LED light bars, 40, 60, 80, and 100 LED units use blanks as needed in place of populated light bars

*** Available on luminaires with 60-120 LEDs

**** Available on luminaires with 40-60 LEDs

***** Must specify voltage other than UL, UL or 34



Rev. Date: 09/27/13



Lighting – Cree Edge (Cambridge Standard Light)

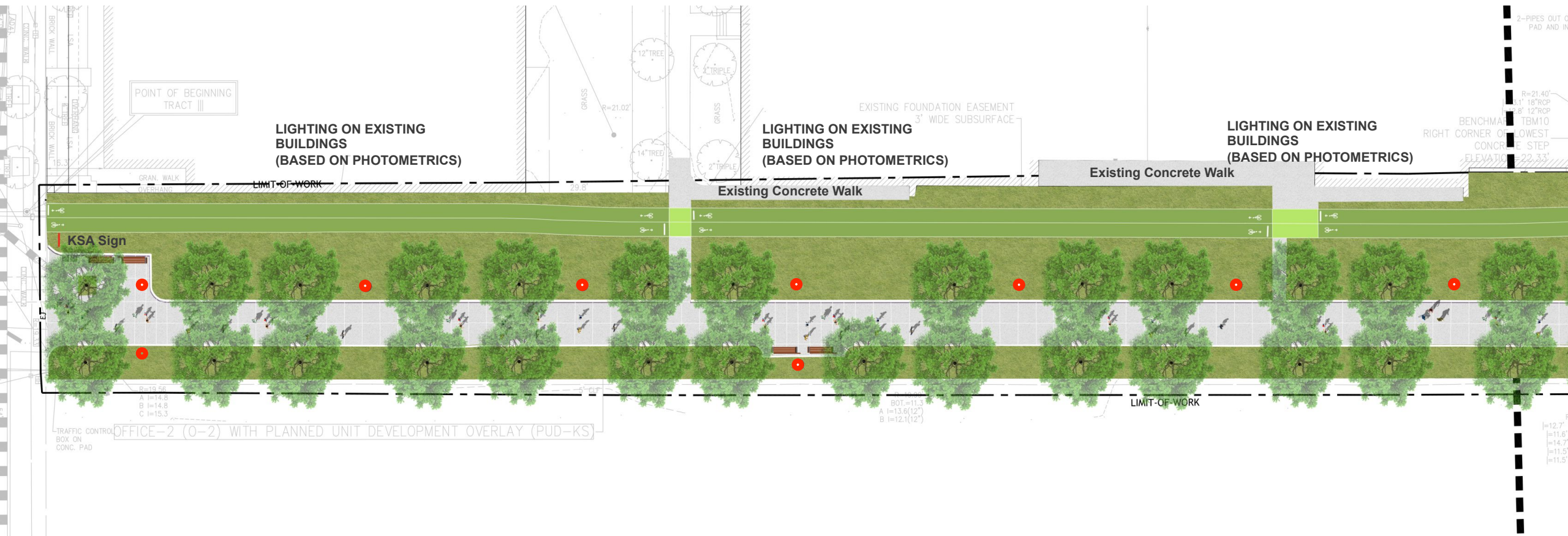

Lighting – Cree Edge (Cambridge Standard Light)



Concrete Pattern / Material

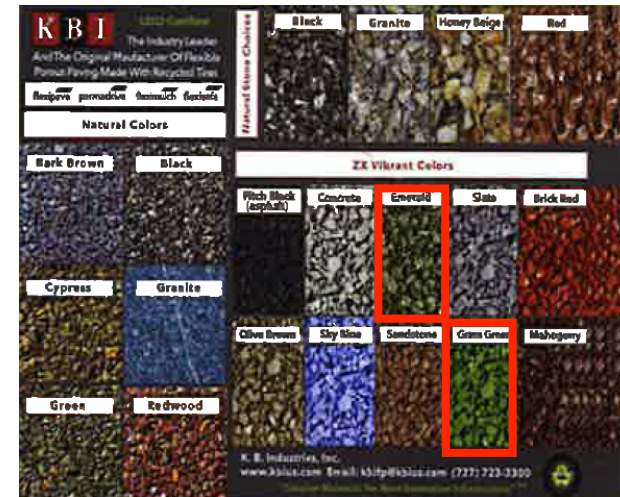
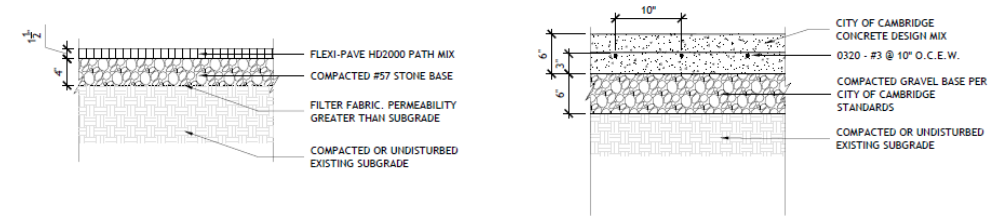
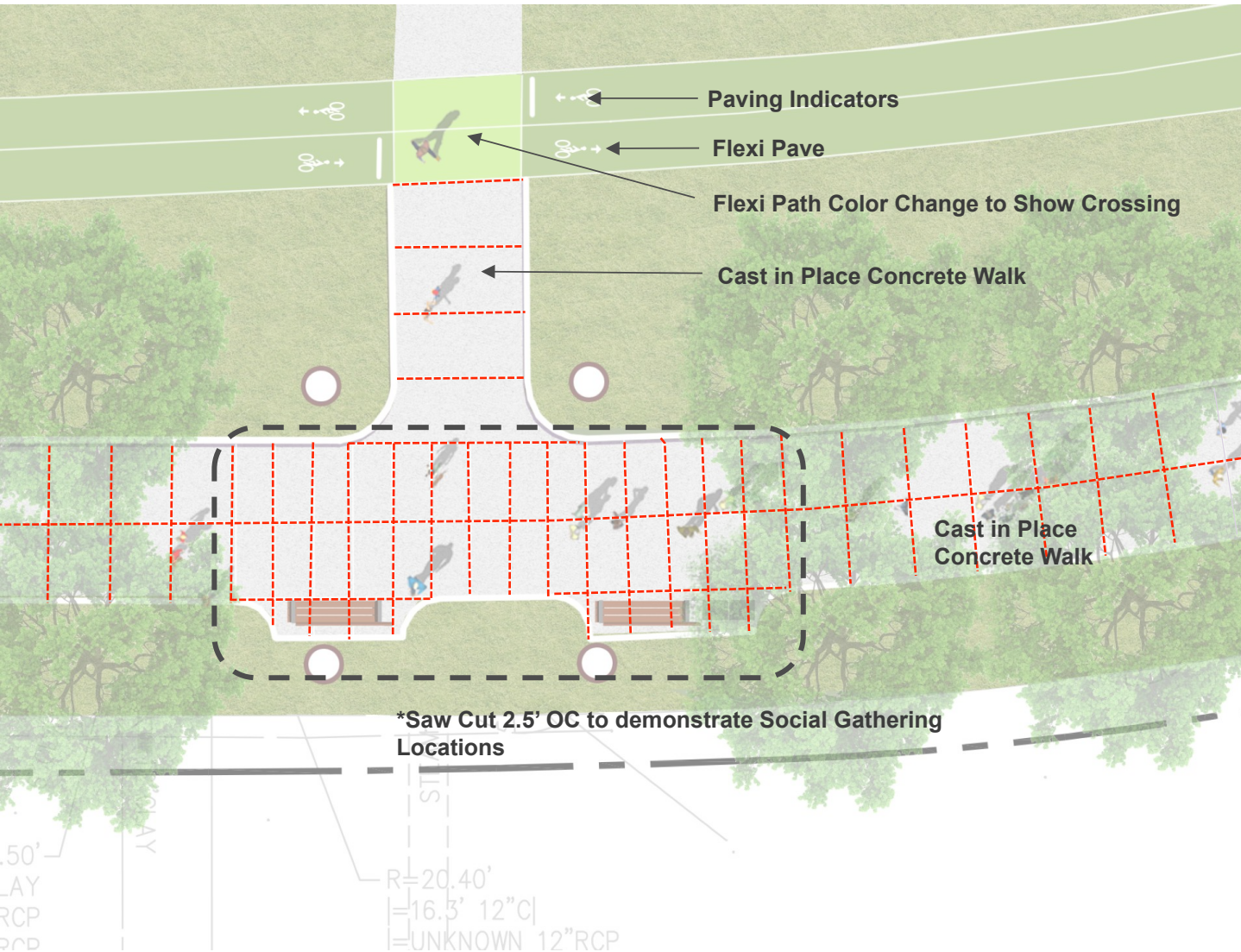

Flexi Pave

Planting



Lack of Light, shade tolerant I for growing conditions
Red Oaks root structure along the surface
Soil depth at a minimum of 3", difficult for container planting
Lack of irrigation, drought tolerant species

Recommendation: Shade Tolerant Creeping Fescue Lawn Mix