

Bank of America



Loc#: 88111

88 Ames Street
Cambridge, MA 02142

ICON



Proposed Sign Schedule

Item	Description	Qty	Page #
1	CUSTOM Dng - HORIZONTAL WALL SIGN	1	7
2	F1ng-b - ILLUMINATED FLAG SIGN	1	8
3	CUSTOM FLAG SCAPE SUSPENDED SIGN	1	9
4	CUSTOM FACE LIT BULL SUSPENDED SIGN	1	10
5	SECURITY CAMERA VINYL	1	11
6	DOOR VINYL - STANDARD w/ ADA DECAL	1	11
7	ML-ISP-.625-S-AL INTERIOR SUITE PLAQUE	1	12
8	MEDIA SCREEN - BY OTHERS	1	13

Drawing prepared by: **SITE PLAN**

Drawing prepared for:

Location: 88 Ames Street
Cambridge, MA 02142

Proj #: 4305

Loc #: 88111

File Path: Active\BANKS\B\Bank Of America\2018\Locations\4305_88111_Cambridge_MA_R7.cdr



Rev #:	Req#:	Date:	Req. By:	Drawn By:	Revision Description:	Rev #:	Req#:	Date:	Req. By:	Drawn By:
Original	301286	07/11/18	SD	Lv		Rev 7	304905	10/10/18	SD	Lv
Rev 1	302023	07/30/18	SD	Lv	Various Changes - See Request	Rev 8	000000	00/00/00	XXX	XXX
Rev 2	302069	08/01/18	SD	Lv	Updated store front sign to new generation design	Rev 9	000000	00/00/00	XXX	XXX
Rev 3	302510	08/15/18	SD	Lv	Updated signs locations - added media screen sign	Rev 10	000000	00/00/00	XXX	XXX
Rev 4	302783	08/23/18	SD	Lv	Updated signs locations					
Rev 5	304039	09/20/18	SD	Lv	Various Changes - See Request					
Rev 6	304571	10/02/18	SD	Lv	Various Changes - See Request					

FIRST FLOOR

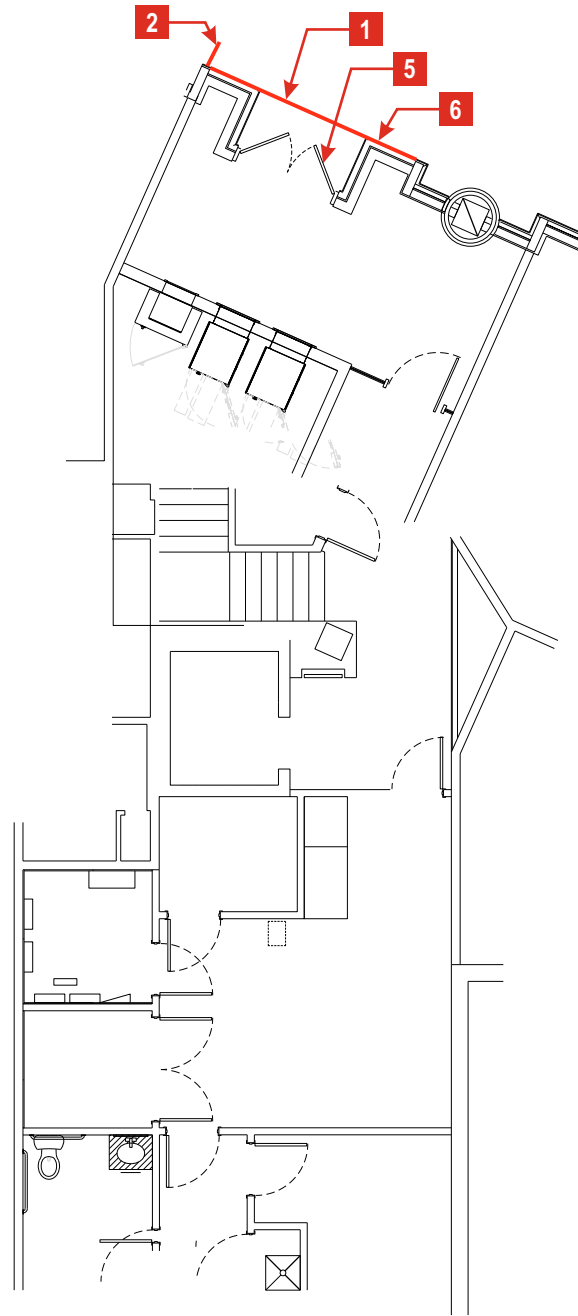

Drawing prepared by:

FLOOR PLAN

Drawing prepared for:



Location: 88 Ames Street
Cambridge, MA 02142

Proj #: 4305

Loc #: 88111

File Path: Active\BANKS\B\Bank Of America\2018\Locations\4305_88111_Cambridge_MA_R7.cdr



Rev #:	Req#:	Date:	Req. By:	Drawn By:	Revision Description:	Drawings are the exclusive property of ICON. Any unauthorized use or duplication is not permitted.				
Original	301286	07/11/18	SD	Lv		Rev #:	Req#:	Date:	Req. By:	Drawn By:
Rev 1	302023	07/30/18	SD	Lv	Various Changes - See Request	Rev 7	304905	10/10/18	SD	Lv
Rev 2	302069	08/01/18	SD	Lv	Updated store front sign to new generation design	Rev 8	000000	00/00/00	XXX	XXX
Rev 3	302510	08/15/18	SD	Lv	Updated signs locations - added media screen sign	Rev 9	000000	00/00/00	XXX	XXX
Rev 4	302783	08/23/18	SD	Lv	Updated signs locations	Rev 10	000000	00/00/00	XXX	XXX
Rev 5	304039	09/20/18	SD	Lv	Various Changes - See Request					
Rev 6	304571	10/02/18	SD	Lv	Various Changes - See Request					Pg. 3

SECOND FLOOR

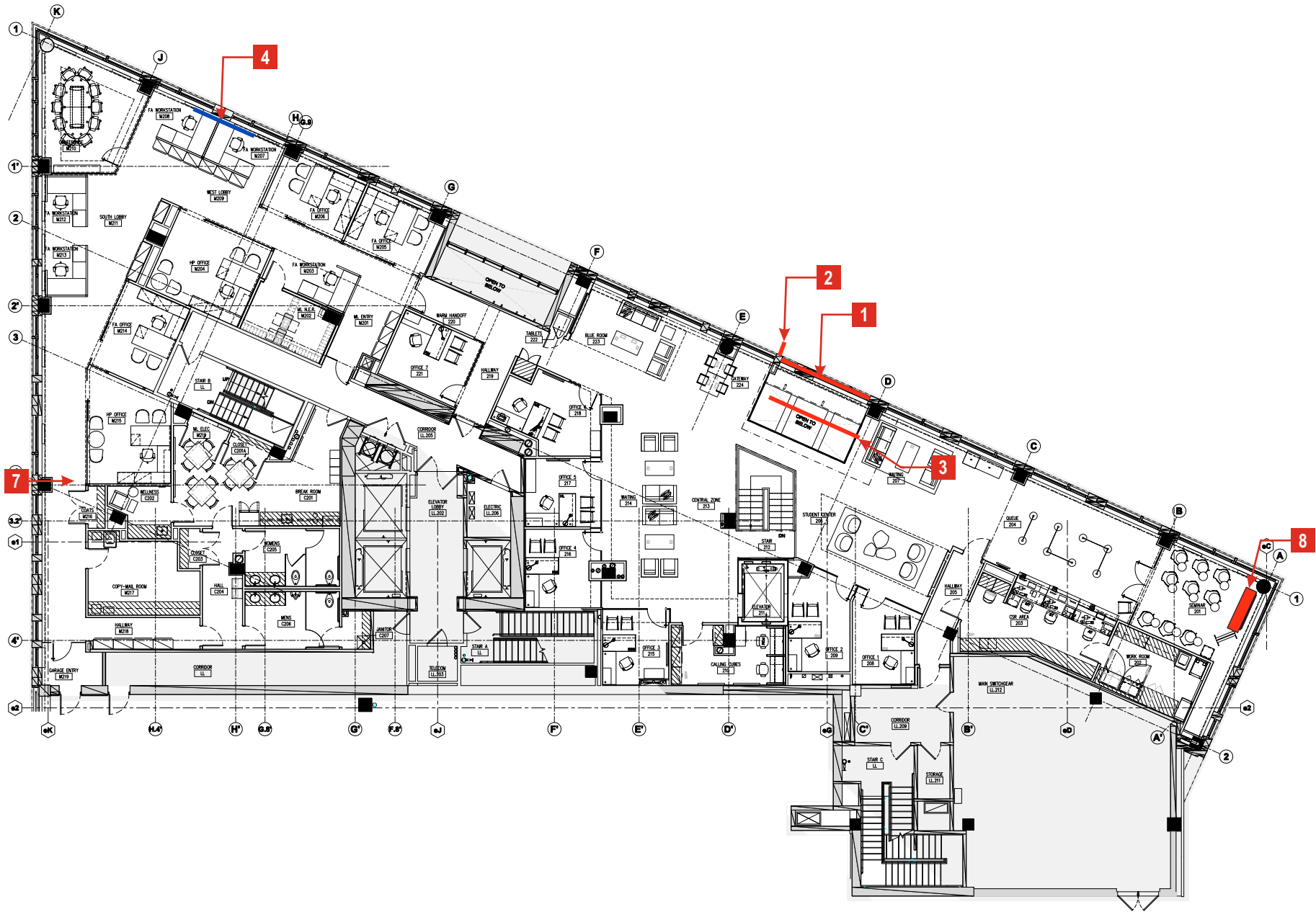

Drawing prepared by:

FLOOR PLAN

Drawing prepared for:



Location: 88 Ames Street
Cambridge, MA 02142

Proj #: 4305
Loc #: 88111

File Path: Active\BANKS\B\Bank Of America\2018\Locations\4305_88111_Cambridge_MA_R7.cdr



Rev #:	Req#:	Date:	Req. By:	Drawn By:	Revision Description:	Drawings are the exclusive property of ICON. Any unauthorized use or duplication is not permitted.				
Original	301286	07/11/18	SD	Lv		Rev #:	Req#:	Date:	Req. By:	Drawn By:
Rev 1	302023	07/30/18	SD	Lv	Various Changes - See Request	Rev 7	304905	10/10/18	SD	Lv
Rev 2	302069	08/01/18	SD	Lv	Updated store front sign to new generation design	Rev 8	000000	00/00/00	XXX	XXX
Rev 3	302510	08/15/18	SD	Lv	Updated signs locations - added media screen sign	Rev 9	000000	00/00/00	XXX	XXX
Rev 4	302783	08/23/18	SD	Lv	Updated signs locations	Rev 10	000000	00/00/00	XXX	XXX
Rev 5	304039	09/20/18	SD	Lv	Various Changes - See Request					
Rev 6	304571	10/02/18	SD	Lv	Various Changes - See Request					



Drawing prepared by:

ELEVATION RENDERING

Drawing prepared for:



Location: 88 Ames Street
Cambridge, MA 02142

Proj #: 4305
Loc #: 88111

File Path:
Active\BANKS\B\Bank Of America\2018\Locations\4305_88111_Cambridge_MA_R7.cdr



Rev #:	Req#:	Date:	Req. By:	Drawn By:	Revision Description:	Drawings are the exclusive property of ICON. Any unauthorized use or duplication is not permitted.					
Original	301286	07/11/18	SD	Lv		Rev #:	Req#:	Date:	Req. By:	Drawn By:	
Rev 1	302023	07/30/18	SD	Lv	Various Changes - See Request	Rev 7	304905	10/10/18	SD	Lv	
Rev 2	302069	08/01/18	SD	Lv	Updated store front sign to new generation design	Rev 8	000000	00/00/00	XXX	XXX	
Rev 3	302510	08/15/18	SD	Lv	Updated signs locations - added media screen sign	Rev 9	000000	00/00/00	XXX	XXX	
Rev 4	302783	08/23/18	SD	Lv	Updated signs locations	Rev 10	000000	00/00/00	XXX	XXX	
Rev 5	304039	09/20/18	SD	Lv	Various Changes - See Request						
Rev 6	304571	10/02/18	SD	Lv	Various Changes - See Request						



ELEVATION - FRONT ENTRANCE

SCALE: NOT TO SCALE

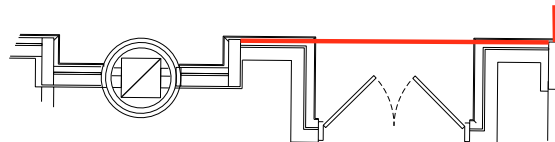

Drawing prepared by:

PHOTO ELEVATION

Drawing prepared for:



Location:
88 Ames Street
Cambridge, MA 02142

Proj #:
4305
Loc #:
88111



File Path:
Active\BANKS\B\Bank Of America\2018\Locations\4305_88111_Cambridge_MA_R7.cdr

Rev #:	Req#:	Date:	Req. By:	Drawn By:	Revision Description:	Rev #:	Req#:	Date:	Req. By:	Drawn By:
Original	301286	07/11/18	SD	Lv						
Rev 1	302023	07/30/18	SD	Lv	Various Changes - See Request	Rev 7	304905	10/10/18	SD	Lv
Rev 2	302069	08/01/18	SD	Lv	Updated store front sign to new generation design	Rev 8	000000	00/00/00	XXX	XXX
Rev 3	302510	08/15/18	SD	Lv	Updated signs locations - added media screen sign	Rev 9	000000	00/00/00	XXX	XXX
Rev 4	302783	08/23/18	SD	Lv	Updated signs locations	Rev 10	000000	00/00/00	XXX	XXX
Rev 5	304039	09/20/18	SD	Lv	Various Changes - See Request					
Rev 6	304571	10/02/18	SD	Lv	Various Changes - See Request					

Drawings are the exclusive property of ICON. Any unauthorized use or duplication is not permitted.

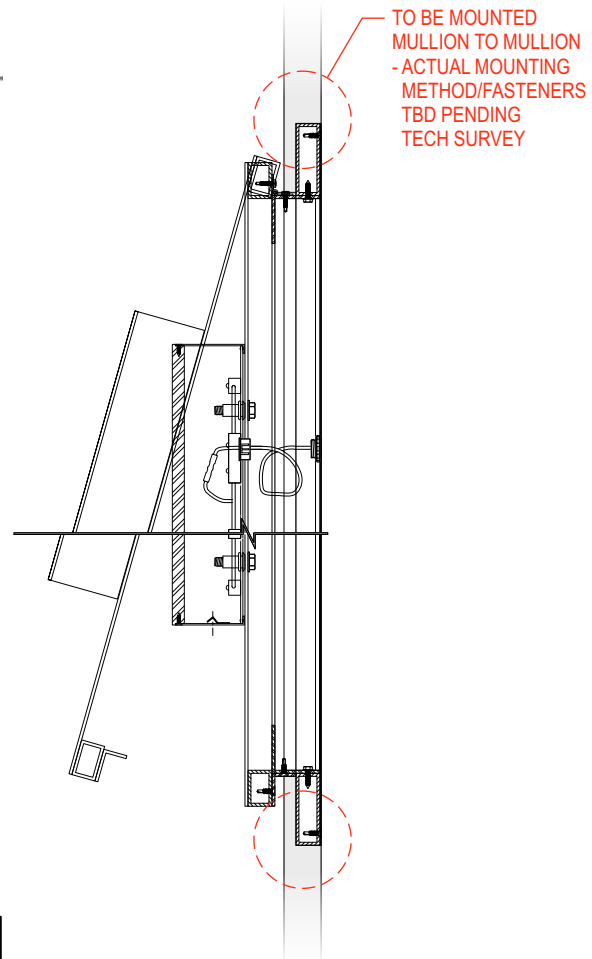
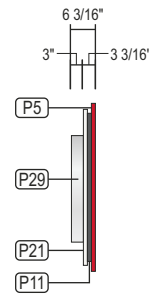
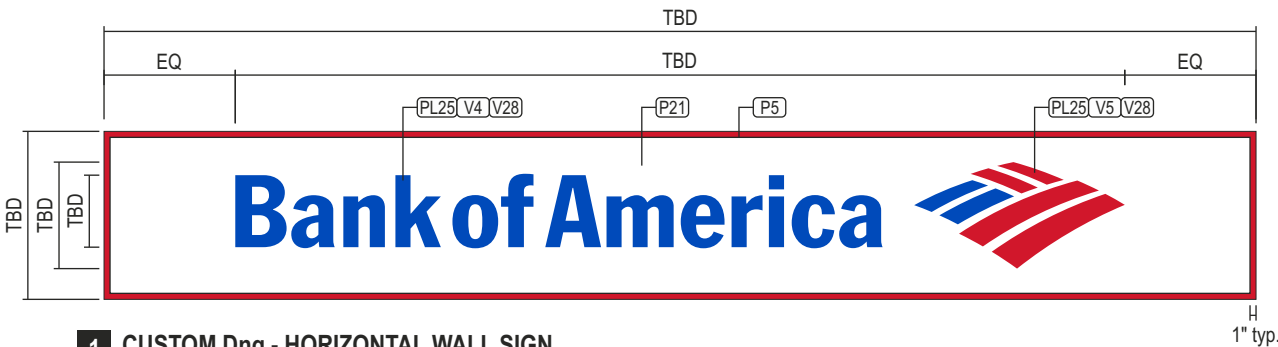
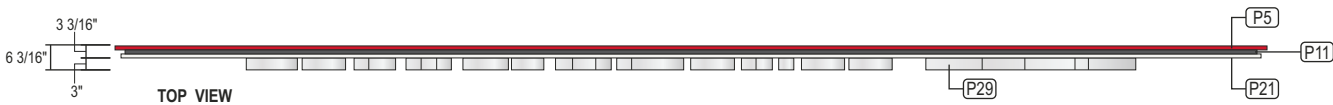

1 CUSTOM Dng - HORIZONTAL WALL SIGN

QTY: 1

SCALE: 3/8"=1'-0"

STANDARD SPECS - SEE COLOR SPECIFICATION LIBRARY

ELECTRICAL	
LEDS	Agilight LS-PROCLR-TRD-2B5 (RED) Agilight LS-PROCLR-BLU-2B5 (BLUE)
P.S.	AGILIGHT T.B.D.
AMPS	TBD
V.A.	120 VOLTS WATTS TBD
CIRCUITS	1-20 AMP

THIS SIGN IS INTENDED TO BE INSTALLED IN ACCORDANCE WITH THE REQUIREMENTS OF ARTICLE 600 OF THE NATIONAL ELECTRICAL CODE AND/OR OTHER APPLICABLE LOCAL CODES. THIS INCLUDES PROPER GROUNDING AND BONDING OF SIGN.



TOLERANCE: ± 1/16" ON ALL DIMENSIONS

USE WHITE SILICONE TO CONCEAL LIGHT LEAKS

NOTE: LETTER LAYOUT SHOWN FOR GRAPHICAL REPRESENTATION ONLY. SEE ARTWORK FOR PRODUCTION.

DESIGN LOADS:
115 MPH WIND LOAD
RISK CATEGORY II, EXPOSURE C.
2012 INTERNATIONAL BUILDING CODE, ASCE 7-10

SECTION				
ANCHOR TYPE	Ø1/2" SLEEVE ANCHOR (Ø3/8" BOLT), 2" MINIMUM EMBEDMENT	Ø3/8" EXPANSION ANCHOR, 2 1/2" MINIMUM EMBEDMENT	Ø3/8" THREADED ROD	Ø3/8" THREADED ROD w/ALUMINUM OR PVC COMPRESSION SLEEVE
WALL TYPE	CMU, BRICK	PRE-CAST CONCRETE, CONCRETE	WOOD, CONCRETE BLOCK, EIFS WALL SYSTEMS	EIFS WALL w/ FOAM INSULATION

MOUNTING OPTIONS

SCALE: N.T.S.

WEIGHT
ESTIMATED SIGN WEIGHT:
Lb.

SECTION A-A SCALE: NOT TO SCALE



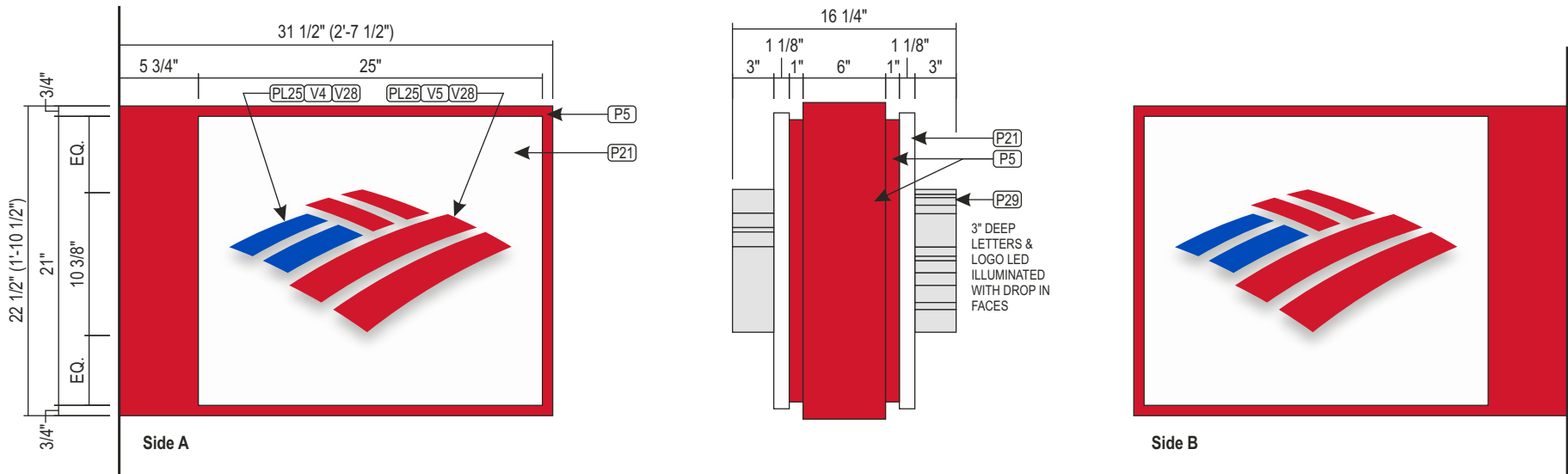

2 F1ng-b - ILLUMINATED FLAG SIGN - LOGO ONLY - 3.646 SQ. FT.

QTY: 1

SCALE: 1"=1'-0"

STANDARD SPECS - SEE COLOR SPECIFICATION LIBRARY
ACTUAL FABRICATION SPECS TBD.

THIS SIGN IS INTENDED TO BE INSTALLED IN ACCORDANCE WITH THE REQUIREMENTS OF ARTICLE 600 OF THE NATIONAL ELECTRICAL CODE AND/OR OTHER APPLICABLE LOCAL CODES. THIS INCLUDES PROPER GROUNDING AND BONDING OF SIGN.

TOLERANCE: ± 1/16" ON ALL DIMENSIONS

USE WHITE SILICONE TO CONCEAL LIGHT LEAKS

THIS SIGN TO BEAR THIS MARK
 Underwriters Laboratories Inc.
ELECTRIC SIGN

DESIGN LOADS:
115 MPH WIND LOAD
RISK CATEGORY II, EXPOSURE C.
2012 INTERNATIONAL BUILDING CODE, ASCE 7-10

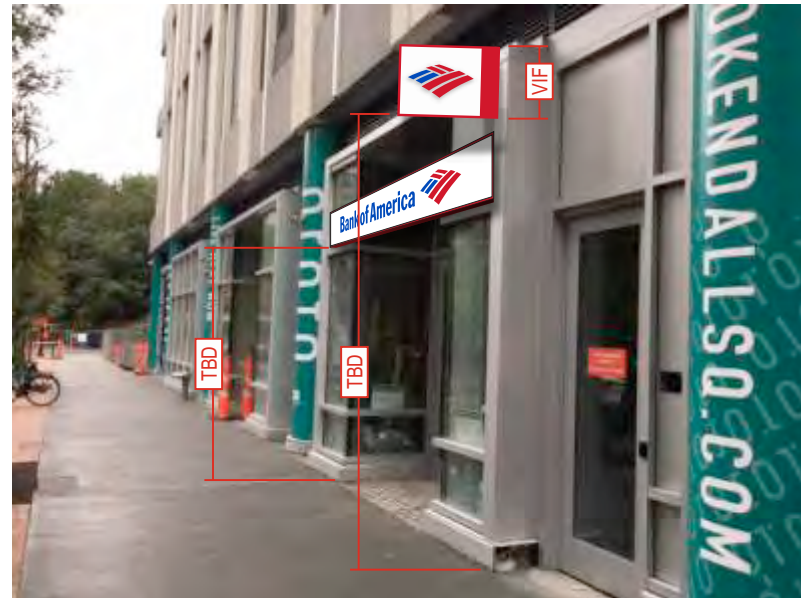

Drawing prepared by:

RECOMMENDATION

Drawing prepared for:



Location: 88 Ames Street
Cambridge, MA 02142
File Path: Active\BANKS\B\Bank Of America\2018\Locations\4305_88111_Cambridge_MA_R7.cdr

Proj #: 4305
Loc #: 88111



Rev #:	Req#:	Date:	Req. By:	Drawn By:	Revision Description:	Drawings are the exclusive property of ICON. Any unauthorized use or duplication is not permitted.
Original	301286	07/11/18	SD	Lv		
Rev 1	302023	07/30/18	SD	Lv	Various Changes - See Request	
Rev 2	302069	08/01/18	SD	Lv	Updated store front sign to new generation design	Rev #: 304905 Date: 10/10/18 Req. By: SD Drawn By: Lv
Rev 3	302510	08/15/18	SD	Lv	Updated signs locations - added media screen sign	Rev 7 000000 00/00/00 XXX XXX
Rev 4	302783	08/23/18	SD	Lv	Updated signs locations	Rev 8 000000 00/00/00 XXX XXX
Rev 5	304039	09/20/18	SD	Lv	Various Changes - See Request	Rev 9 000000 00/00/00 XXX XXX
Rev 6	304571	10/02/18	SD	Lv	Various Changes - See Request	Rev 10 000000 00/00/00 XXX XXX

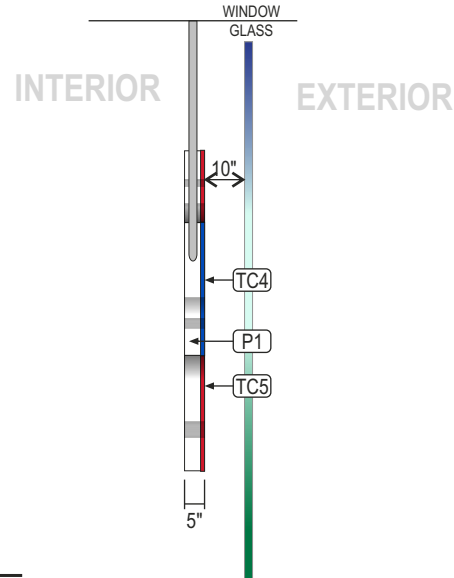
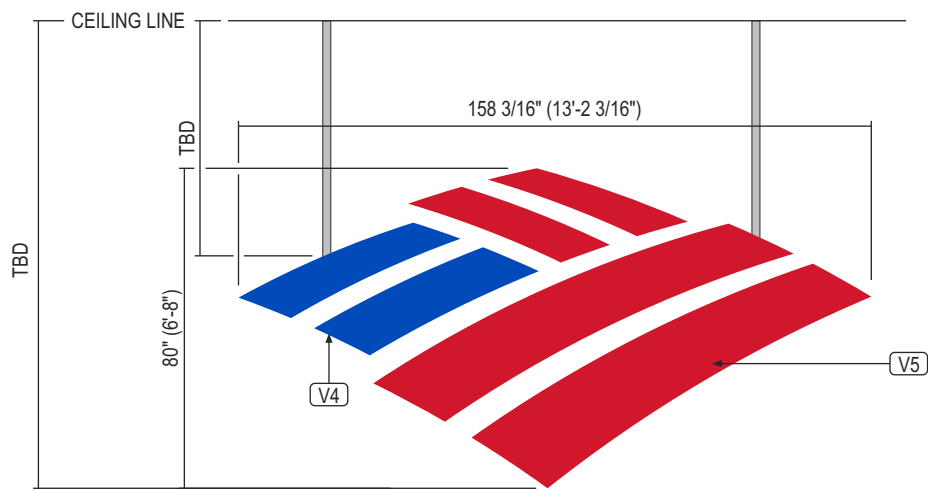

3 CUSTOM S/F FACE LIT FLAG SCAPE SUSPENDED SIGN

QTY: 1

SCALE: 1/4"=1'-0"

STANDARD SPECS - SEE COLOR SPECIFICATION LIBRARY
ACTUAL FABRICATION SPECS TBD.

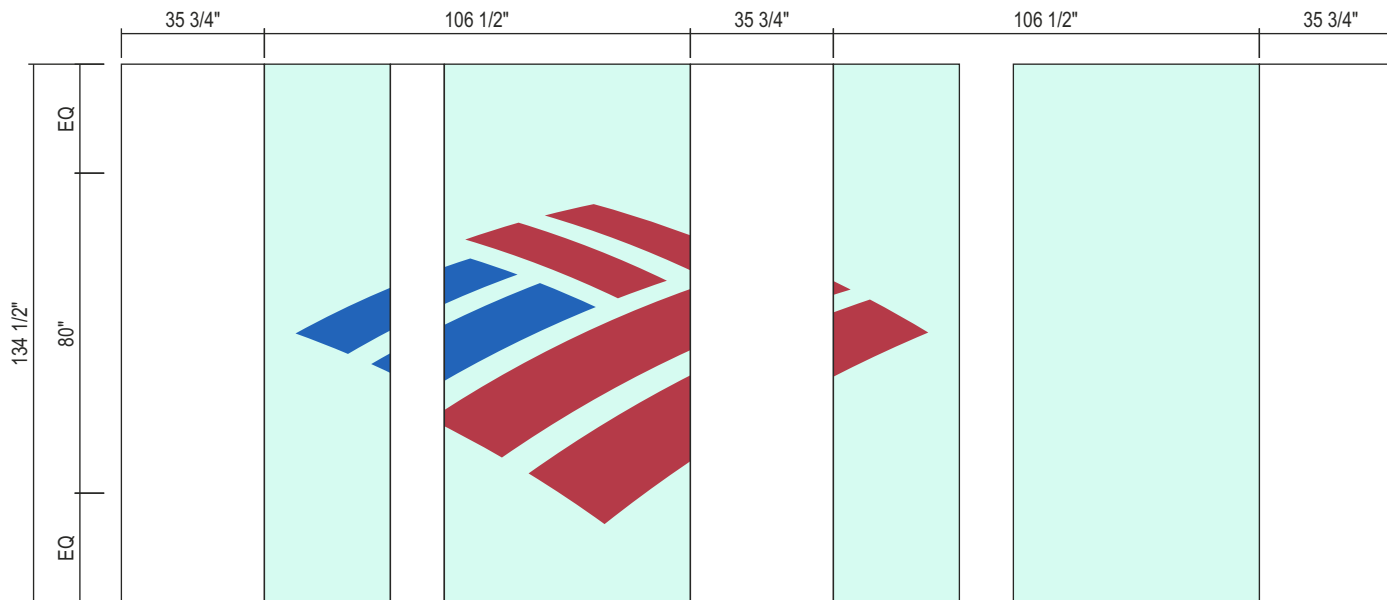

ELEVATION - EXTERIOR LAYOUT VIEW

SCALE: 1/4"=1'-0"

Drawing prepared by:

RECOMMENDATION

Drawing prepared for:



Location:
88 Ames Street
Cambridge, MA 02142

Proj #:
4305
Loc #:
88111



File Path:
Active\BANKS\B\Bank Of America\2018\Locations\4305_88111_Cambridge_MA_R7.cdr

Rev #:	Req#:	Date:	Req. By:	Drawn By:	Revision Description:	Drawings are the exclusive property of ICON. Any unauthorized use or duplication is not permitted.				
Original	301286	07/11/18	SD	Lv		Rev #:	Req#:	Date:	Req. By:	Drawn By:
Rev 1	302023	07/30/18	SD	Lv	Various Changes - See Request	Rev 7	304905	10/10/18	SD	Lv
Rev 2	302069	08/01/18	SD	Lv	Updated store front sign to new generation design	Rev 8	000000	00/00/00	XXX	XXX
Rev 3	302510	08/15/18	SD	Lv	Updated signs locations - added media screen sign	Rev 9	000000	00/00/00	XXX	XXX
Rev 4	302783	08/23/18	SD	Lv	Updated signs locations	Rev 10	000000	00/00/00	XXX	XXX
Rev 5	304039	09/20/18	SD	Lv	Various Changes - See Request					
Rev 6	304571	10/02/18	SD	Lv	Various Changes - See Request					

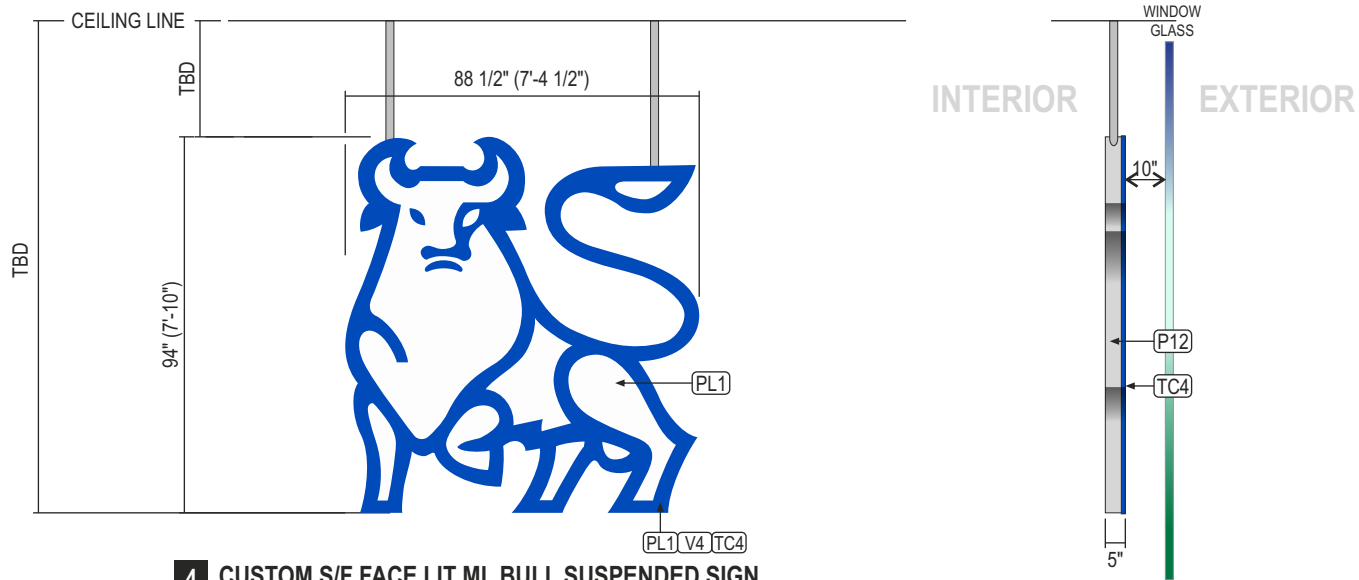

4 CUSTOM S/F FACE LIT ML BULL SUSPENDED SIGN

QTY: 1

SCALE: 1/4"=1'-0"

STANDARD SPECS - SEE COLOR SPECIFICATION LIBRARY
ACTUAL FABRICATION SPECS TBD.

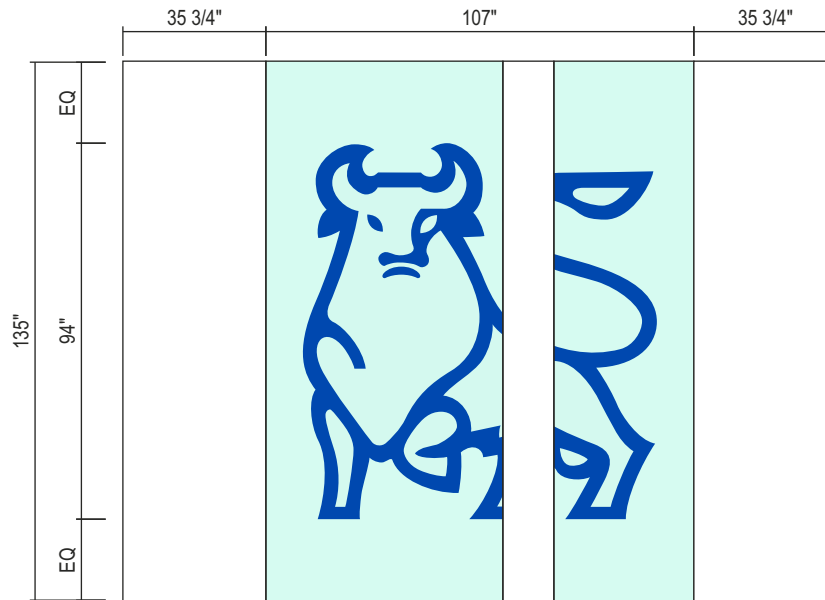

ELEVATION - EXTERIOR LAYOUT VIEW

SCALE: 1/4"=1'-0"

Drawing prepared by:

RECOMMENDATION

Drawing prepared for:



Location: 88 Ames Street
Cambridge, MA 02142
File Path: Active\BANKS\B\Bank Of America\2018\Locations\4305_88111_Cambridge_MA_R7.cdr

Proj #: 4305
Loc #: 88111



Rev #:	Req#:	Date:	Req. By:	Drawn By:	Revision Description:	Drawings are the exclusive property of ICON. Any unauthorized use or duplication is not permitted.
Original	301286	07/11/18	SD	Lv		
Rev 1	302023	07/30/18	SD	Lv	Various Changes - See Request	
Rev 2	302069	08/01/18	SD	Lv	Updated store front sign to new generation design	Rev #: 304905 Date: 10/10/18 Req. By: SD Drawn By: Lv
Rev 3	302510	08/15/18	SD	Lv	Updated signs locations - added media screen sign	Rev 7 000000 00/00/00 XXX XXX
Rev 4	302783	08/23/18	SD	Lv	Updated signs locations	Rev 8 000000 00/00/00 XXX XXX
Rev 5	304039	09/20/18	SD	Lv	Various Changes - See Request	Rev 9 000000 00/00/00 XXX XXX
Rev 6	304571	10/02/18	SD	Lv	Various Changes - See Request	Rev 10 000000 00/00/00 XXX XXX

MATERIALS/APPLICATION

- A. WHITE 3M #7725-10 vinyl graphics.
- B. Apply all vinyl with the exception of the handicap symbol of accessibility on second surface when glass is clear to medium tint
- C. **Apply vinyls on first surface when glass is dark tinted.**
- D. Typeface is to be Franklin-Gothic-Demi-Condensed. Use only this font. Substitute fonts are not allowed.
- E. Note: Hours information to be verified with the Branch Manager.
- All optional information must be provided through inspection of site from technical audit
- F. Preferred position of 13' x 12' Acrylic Holder.
- Holder by others on second surface of opposite door across from hours decals, as shown
- G. Handicap symbol to be reverse silkscreened blue field on white 3M #7725-10 vinyl. Symbol of accessibility to reverse out white. Use UV inks manufactured by Sericol or approved equal. Blue field to match PMS 7462C, finish to meet 70% gloss ADA compliance requirements. When required, always apply handicap vinyl to exterior of glass.
- VINYLS: (Always refer to State-specific pages to check for regional layouts or copy)**
- 1. Inline Signature format - Always use Master Brand.
- 2. Lobby Hours - Always use. Maintain flush left alignment of days and flush right alignment of hours information as shown.
- 3. ATA Copy - Always use if applicable. Maintain flush left alignment of days and flush right alignment of hours information as shown.
- 4. 'Also visit the ATM, bankofamerica.com and www.bofa.mobi' - Always use.
- 5. Non-employees may not solicit or distribute materials - Always use.
- 6. Handicap symbol - Use only on accessible entrance doors. For non accessible entrances see sheets 19 and 20. Single handicap symbol alone should be used to denote a handicap entrance.
- 7. No Smoking symbol - Always use.
- 8. 'NO PETS PLEASE' - Always use.
- 9. ATM location information - If ATM redirect copy exists remove only- do not replace.
- 10. 'NOTICE: This facility may be used only to transact banking business. NO TRESPASSING. Police take notice.' - Always use.
- 11. 'In case of emergency, contact Bank of America Security 1-800-222-7511' - Always use

NOTE: If entry door crash bar or other obstructions are on the front of the door, space copy above or below as required. Provide a minimum space of 1" above and 2" below the obstruction or crash bar. Maintain a minimum of 4' above bottom mullion. If there is not enough space to apply necessary copy, convert to a door plaque. Placement of crash bar and dimensions of bottom mullion are shown in example only, field verify exact conditions prior to fabrication .

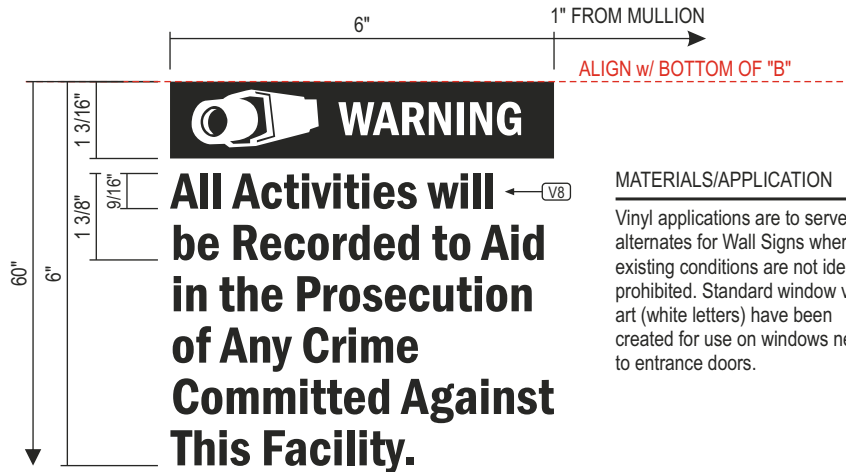

MATERIALS/APPLICATION
Vinyl applications are to serve as alternates for Wall Signs where existing conditions are not ideal or prohibited. Standard window vinyl art (white letters) have been created for use on windows next to entrance doors.

5 SECURITY CAMERA VINYL

QTY: 1
VINYL SHOULD BE MOUNTED 1" FROM MULLION
FIRST SURFACE APPLICATION

SCALE: 1:3

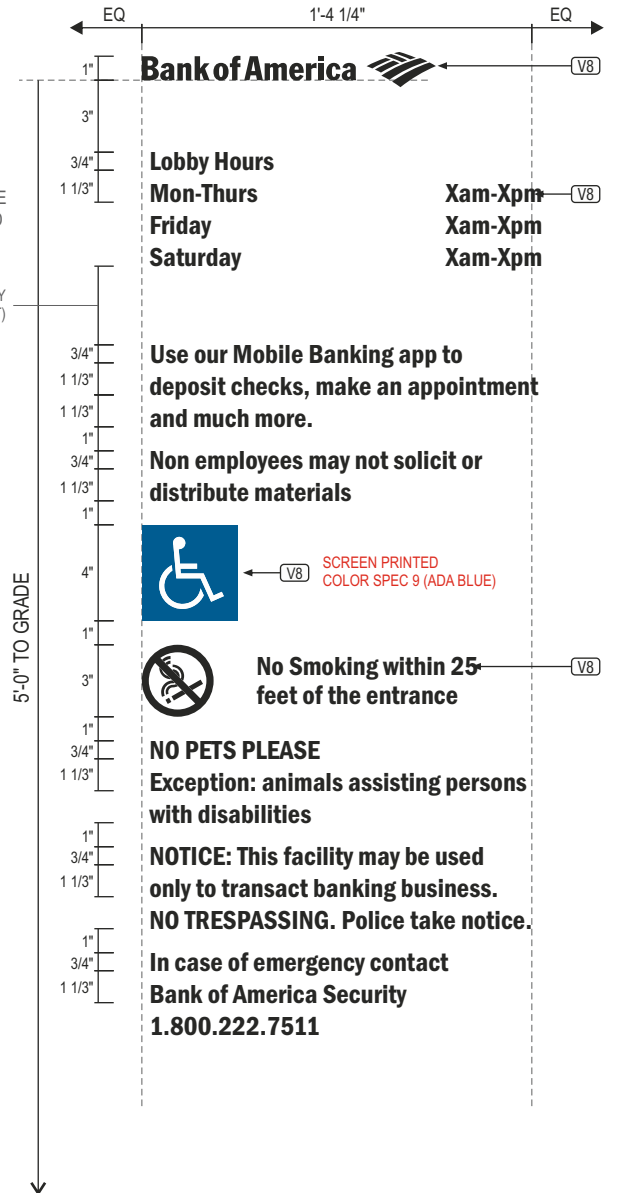

6 DOOR VINYL - STANDARD w/ ADA DECAL

QTY: 1
FIRST SURFACE APPLICATION

SCALE: 1 1/2"=1'-0"

Drawing prepared by:

RECOMMENDATION

Drawing prepared for:



Location:
88 Ames Street
Cambridge, MA 02142

Proj #:
4305

Loc #:
88111



File Path:
Active\BANKS\B\Bank Of America\2018\Locations\4305_88111_Cambridge_MA_R7.cdr

Rev #:	Req#:	Date:	Req. By:	Drawn By:	Revision Description:	Drawings are the exclusive property of ICON. Any unauthorized use or duplication is not permitted.
Original	301286	07/11/18	SD	Lv		
Rev 1	302023	07/30/18	SD	Lv	Various Changes - See Request	
Rev 2	302069	08/01/18	SD	Lv	Updated store front sign to new generation design	
Rev 3	302510	08/15/18	SD	Lv	Updated signs locations - added media screen sign	
Rev 4	302783	08/23/18	SD	Lv	Updated signs locations	
Rev 5	304039	09/20/18	SD	Lv	Various Changes - See Request	
Rev 6	304571	10/02/18	SD	Lv	Various Changes - See Request	

Rev #:	Req#:	Date:	Req. By:	Drawn By:
Rev 7	304905	10/10/18	SD	Lv
Rev 8	000000	00/00/00	XXX	XXX
Rev 9	000000	00/00/00	XXX	XXX
Rev 10	000000	00/00/00	XXX	XXX

Pg. 11

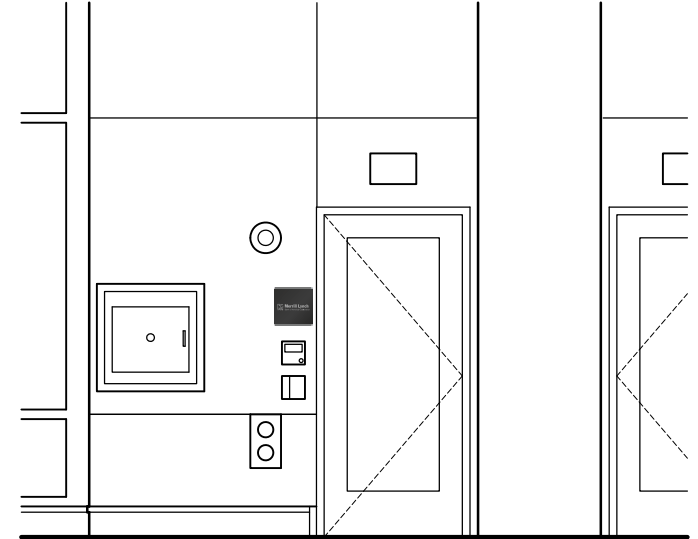
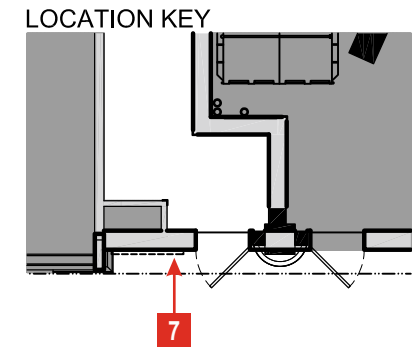
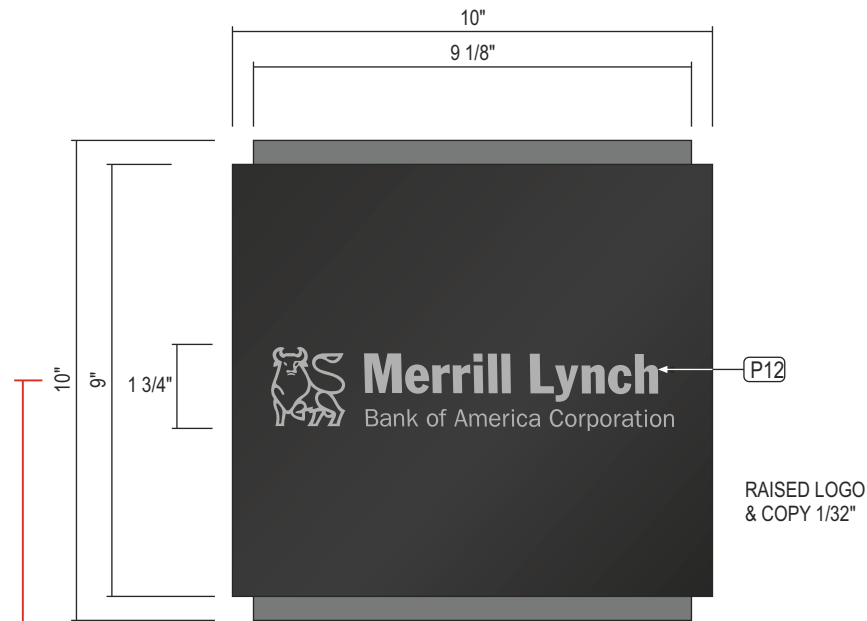

ELEVATION

SCALE: NOT TO SCALE

7 ML-ISP-.625-S-AL INTERIOR SUITE PLAQUE

QTY: 1

SCALE: 3"=1'-0"

STANDARD SPECS - SEE COLOR SPECIFICATION LIBRARY

ADDRESS FONT: FRANKLIN GOTHIC DEMI CONDENSED

5'-0" A.F.F. MAX.



Drawing prepared by:	RECOMMENDATION	Drawing prepared for:
Location:	Proj #:	Bank of America
88 Ames Street	4305	
Cambridge, MA 02142	Loc #:	
File Path:	88111	
Active\BANKS\B\Bank Of America\2018\Locations\4305_88111_Cambridge_MA_R7.cdr		

Rev #:	Req#:	Date:	Req. By:	Drawn By:	Revision Description:	Drawings are the exclusive property of ICON. Any unauthorized use or duplication is not permitted.
Original	301286	07/11/18	SD	Lv		
Rev 1	302023	07/30/18	SD	Lv	Various Changes - See Request	
Rev 2	302069	08/01/18	SD	Lv	Updated store front sign to new generation design	Rev #:
Rev 3	302510	08/15/18	SD	Lv	Updated signs locations - added media screen sign	Rev 7
Rev 4	302783	08/23/18	SD	Lv	Updated signs locations	Rev 8
Rev 5	304039	09/20/18	SD	Lv	Various Changes - See Request	Rev 9
Rev 6	304571	10/02/18	SD	Lv	Various Changes - See Request	Rev 10
						000000
						00/00/00
						XXX
						XXX
						XXX
						XXX
						Pg. 12

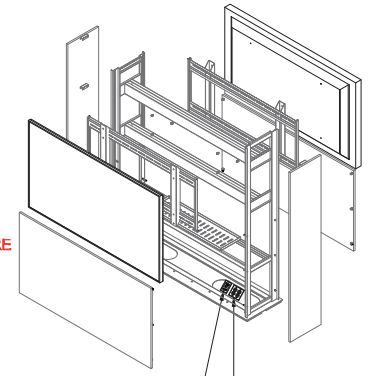
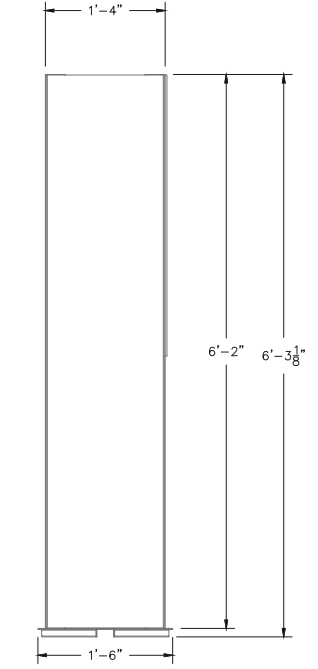
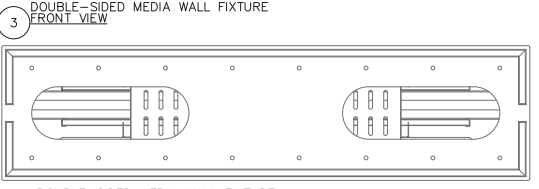
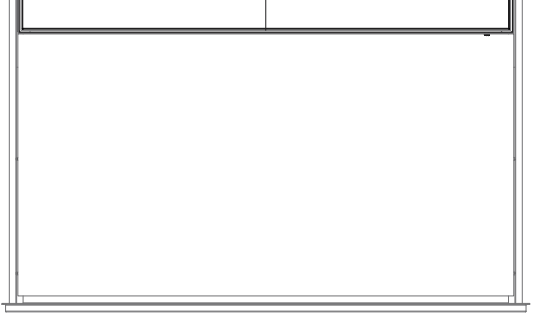
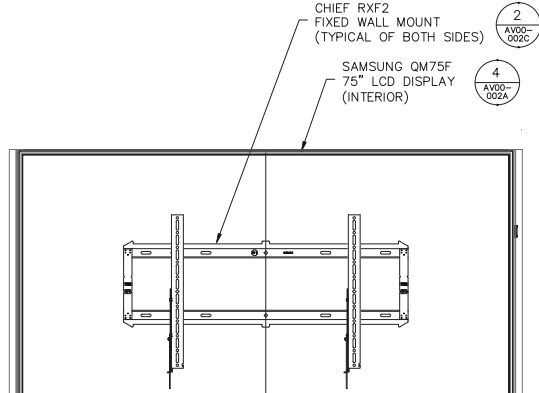
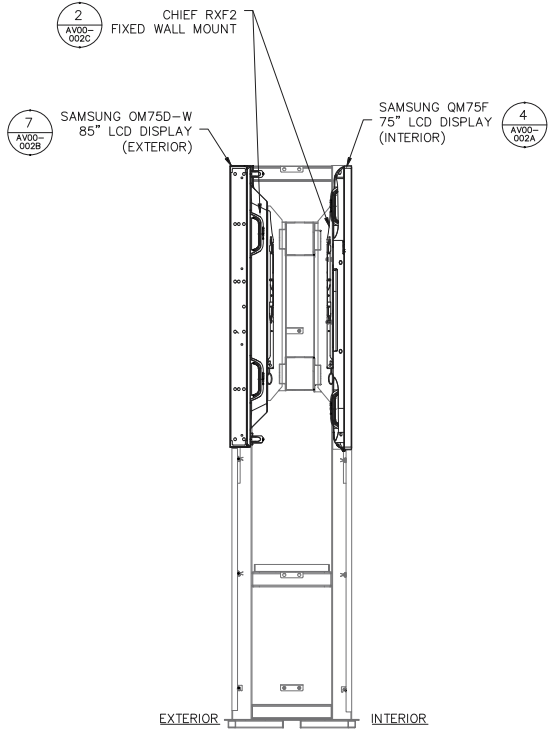
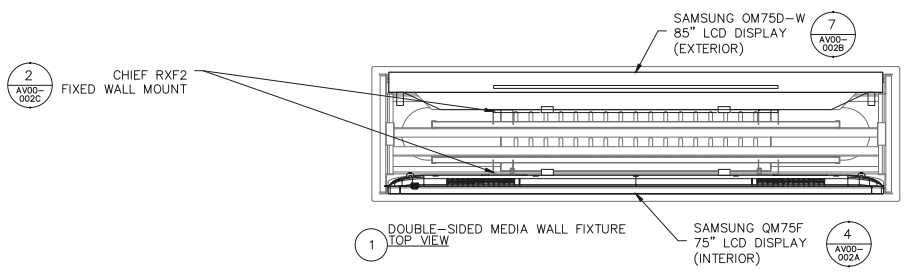

G.G. TO BRING (1) 1" POWER CONDUIT AND (1) 1 1/2" DATA CONDUIT INTO BASE FOR TERMINATION WITHIN FIXTURE

(2) SHIELDED RJ45 RECEPTACLES FOR AV WIRING IN FLOOR BOX
 QUAD NEMA 5-20R RECEPTACLE ON 120VAC 20A DEDICATED CIRCUIT IN FLOOR BOX

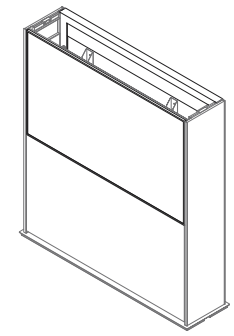

2 DOUBLE-SIDED MEDIA WALL FIXTURE SECTION VIEW

3 DOUBLE-SIDED MEDIA WALL FIXTURE FRONT VIEW

4 DOUBLE-SIDED MEDIA WALL FIXTURE BOTTOM VIEW

5 DOUBLE-SIDED MEDIA WALL FIXTURE SIDE VIEW

6 DOUBLE-SIDED MEDIA WALL FIXTURE EXPLODED ISOMETRIC VIEW

7 DOUBLE-SIDED MEDIA WALL FIXTURE ISOMETRIC VIEW

8 MEDIA SCREEN - BY OTHERS

SCALE: NOT TO SCALE

Drawing prepared by: **RECOMMENDATION**

Location: 88 Ames Street, Cambridge, MA 02142
 File Path: Active\BANKS\B\Bank Of America\2018\Locations\4305_88111_Cambridge_MA_R7.cdr

Proj #: 4305
 Loc #: 88111

Bank of America

Rev #:	Req#:	Date:	Req. By:	Drawn By:	Revision Description:	Drawings are the exclusive property of ICON. Any unauthorized use or duplication is not permitted.				
Original	301286	07/11/18	SD	Lv		Rev #:	Req#:	Date:	Req. By:	Drawn By:
Rev 1	302023	07/30/18	SD	Lv	Various Changes - See Request	Rev 7	304905	10/10/18	SD	Lv
Rev 2	302069	08/01/18	SD	Lv	Updated store front sign to new generation design	Rev 8	000000	00/00/00	XXX	XXX
Rev 3	302510	08/15/18	SD	Lv	Updated signs locations - added media screen sign	Rev 9	000000	00/00/00	XXX	XXX
Rev 4	302783	08/23/18	SD	Lv	Updated signs locations	Rev 10	000000	00/00/00	XXX	XXX
Rev 5	304039	09/20/18	SD	Lv	Various Changes - See Request					
Rev 6	304571	10/02/18	SD	Lv	Various Changes - See Request					

