

BINNEY ST

CAMBRIDGE ST



ALEXANDRIA®

Building the Future of
Life-Changing Innovation™

Grand Junction Rail + Trail



Community Meetings

- Sept • ECPT
 - Wellington Harrington Block Party
- Oct • ECBA
 - Linden Park/ Wellington Harrington
- Nov • Linden Park/Wellington Harrington
- Dec • Filed Zoning Petition
 - ECPT
- Jan • Linden Park/Wellington Harrington
 - ECPT
 - Planning Board
 - Ordinance Committee

Cycling Community Outreach

Friends of Grand Junction Path

Livable Streets

Boston Cyclist Union

Mass Bike

Cambridge Bike Safety





ALEXANDRIA®

Building the Future of
Life-Changing Innovation™

Grand Junction Rail + Trail



ALEXANDRIA®



Building the Future of
Life-Changing Innovation™

Grand Junction Rail + Trail

Grand Junction Path

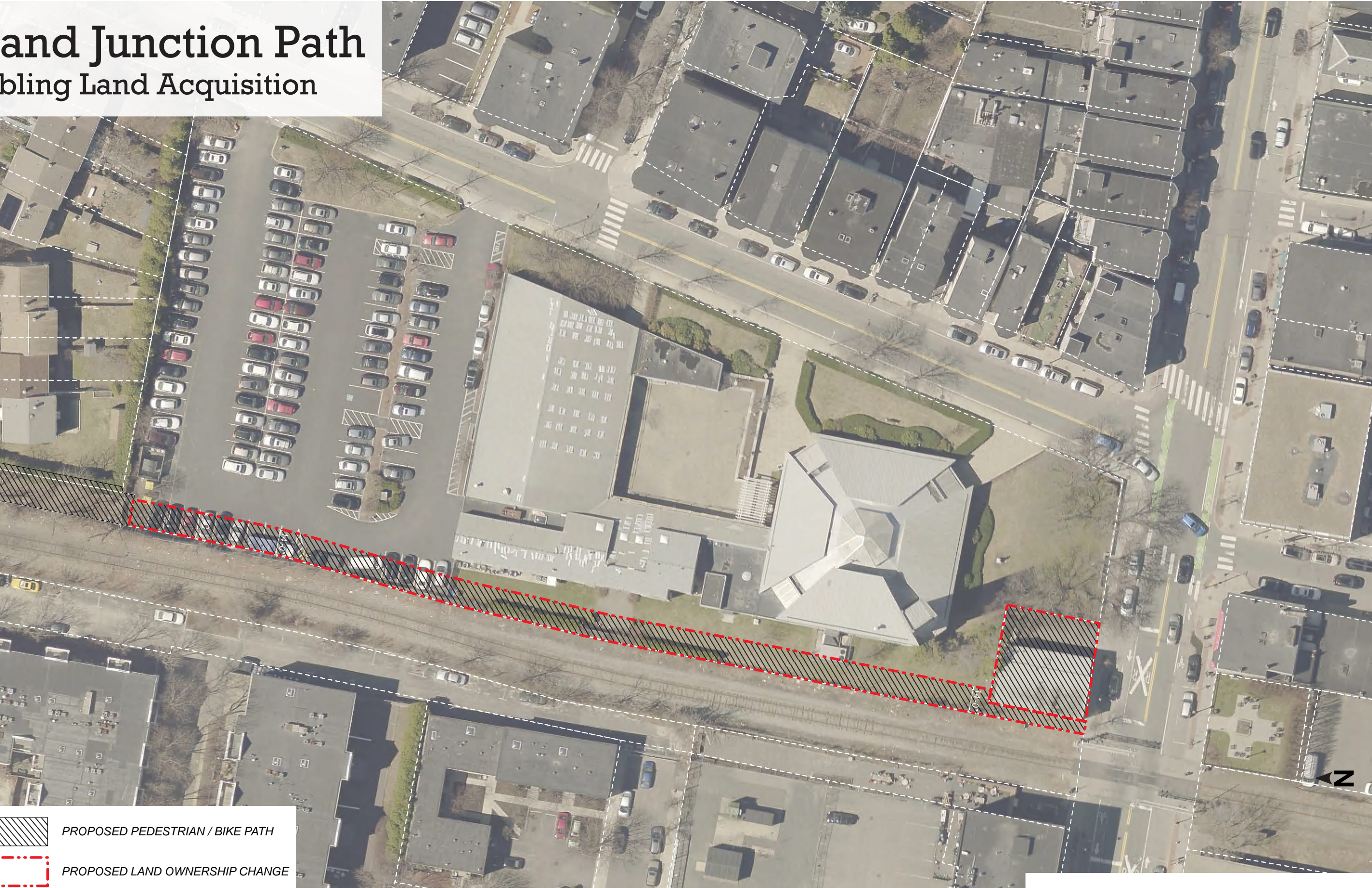
Enabling Land Acquisition



-  PROPOSED PEDESTRIAN / BIKE PATH
-  PROPOSED LAND OWNERSHIP CHANGE
-  PARCEL LINES

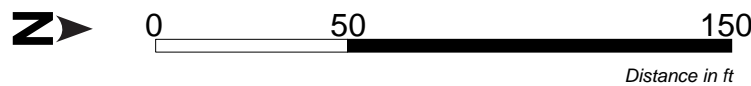

Distance in ft

Grand Junction Path

Existing, Planned, and Proposed Segments



BROADWAY

One Kendall Square

399 Binney

Cinema

OKS Garage

BERKSHIRE ST

CARDINAL MEDEIROS AVE

(Existing Path)

City of Cambridge
(Planned Path,
construction underway)

325 Binney

ARE Controlled
(Proposed Path, ~1,800 lf)

BINNEY ST

ROGERS ST

6TH ST

BENT ST

CHARLES ST

SPRING ST

FULKERSON ST

THORNDIKE ST

OTIS ST

CAMBRIDGE ST

225 Binney



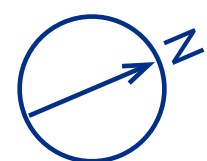
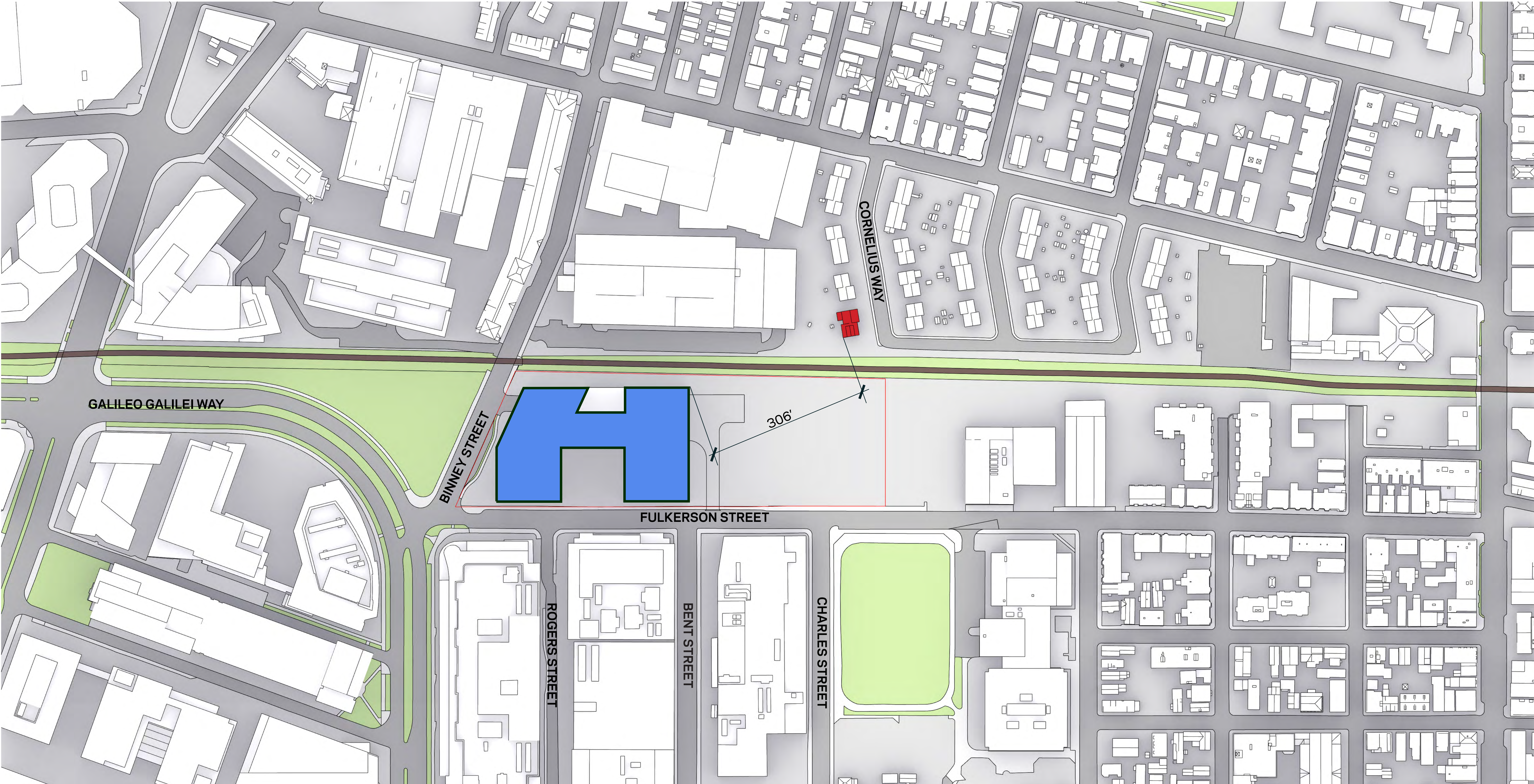

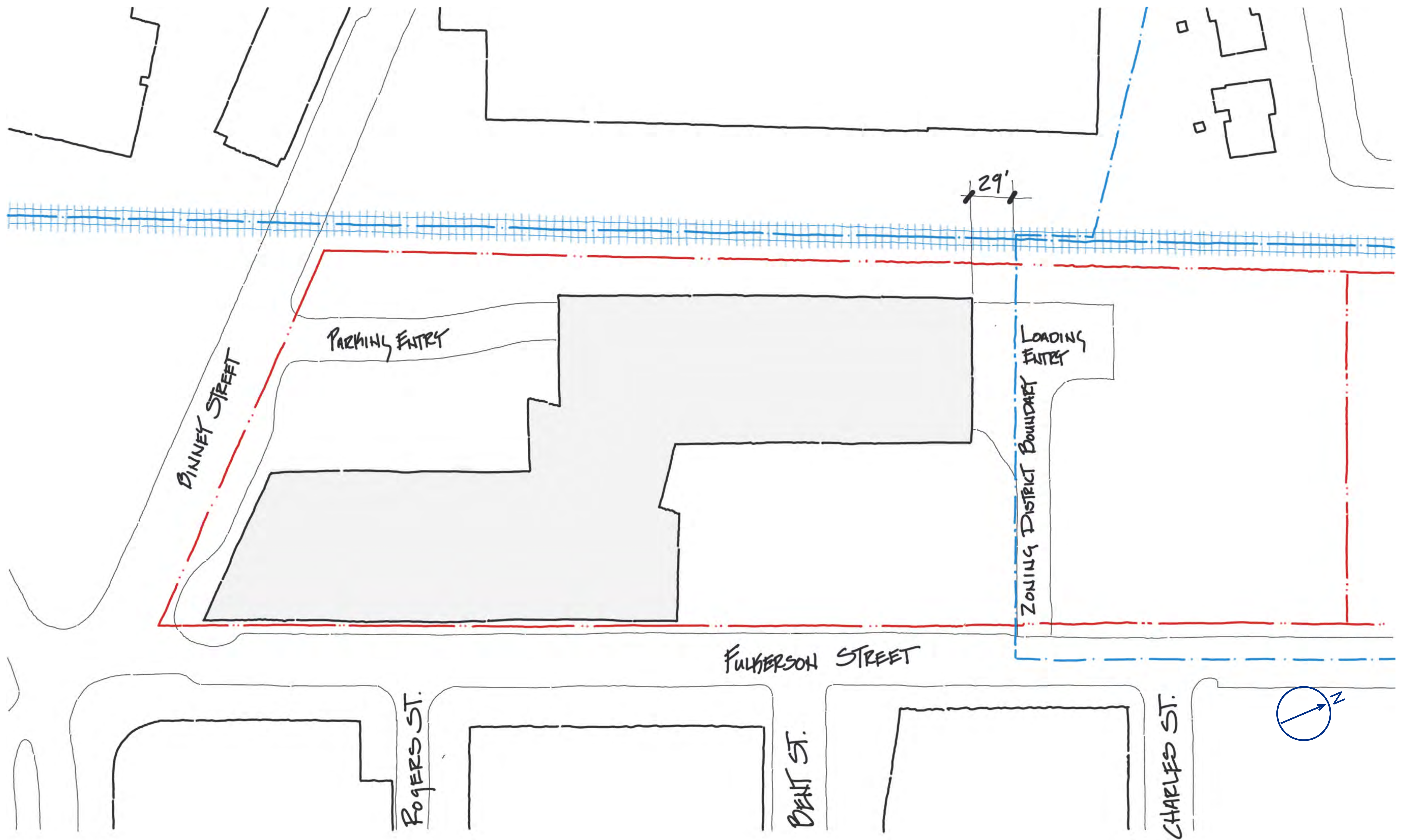

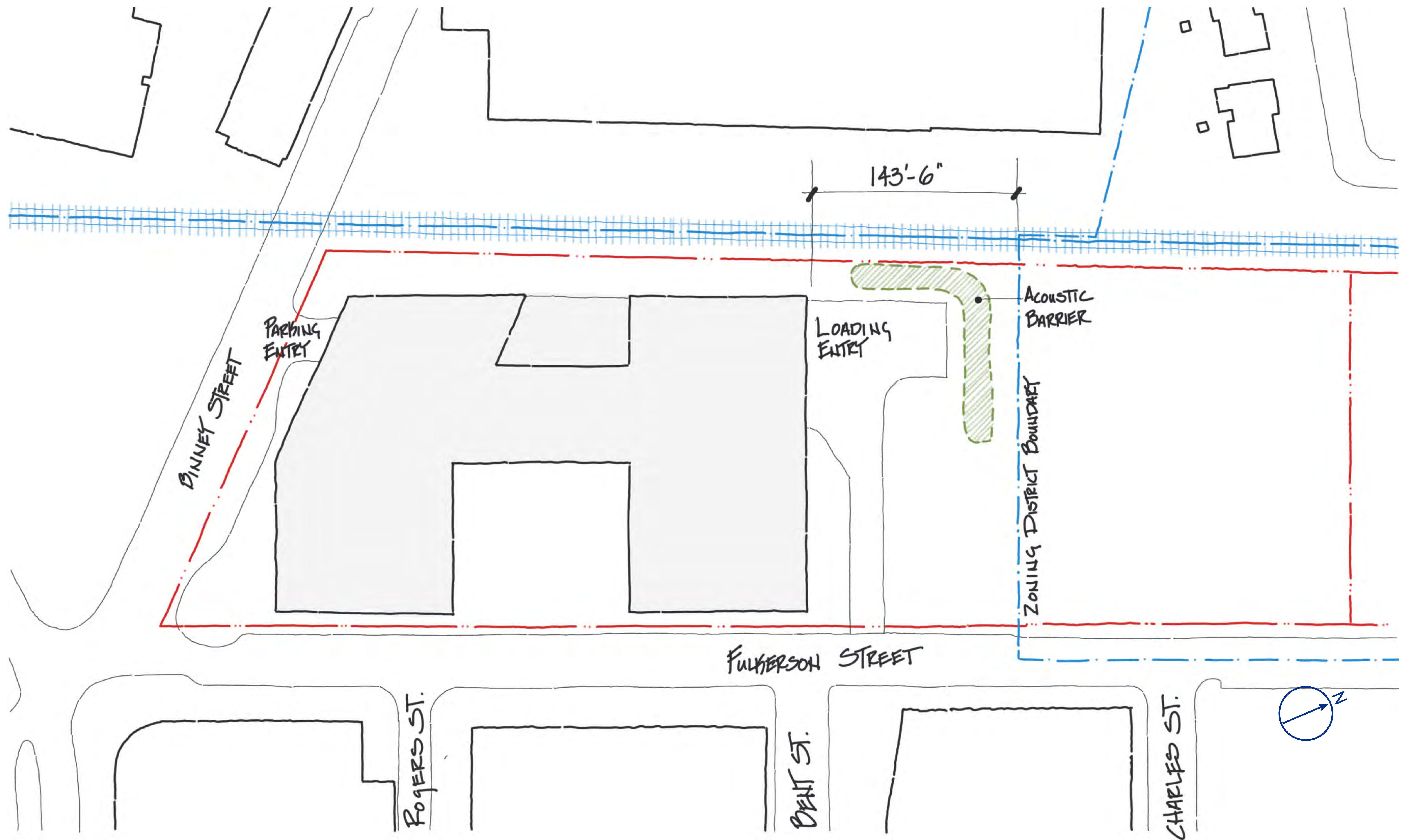

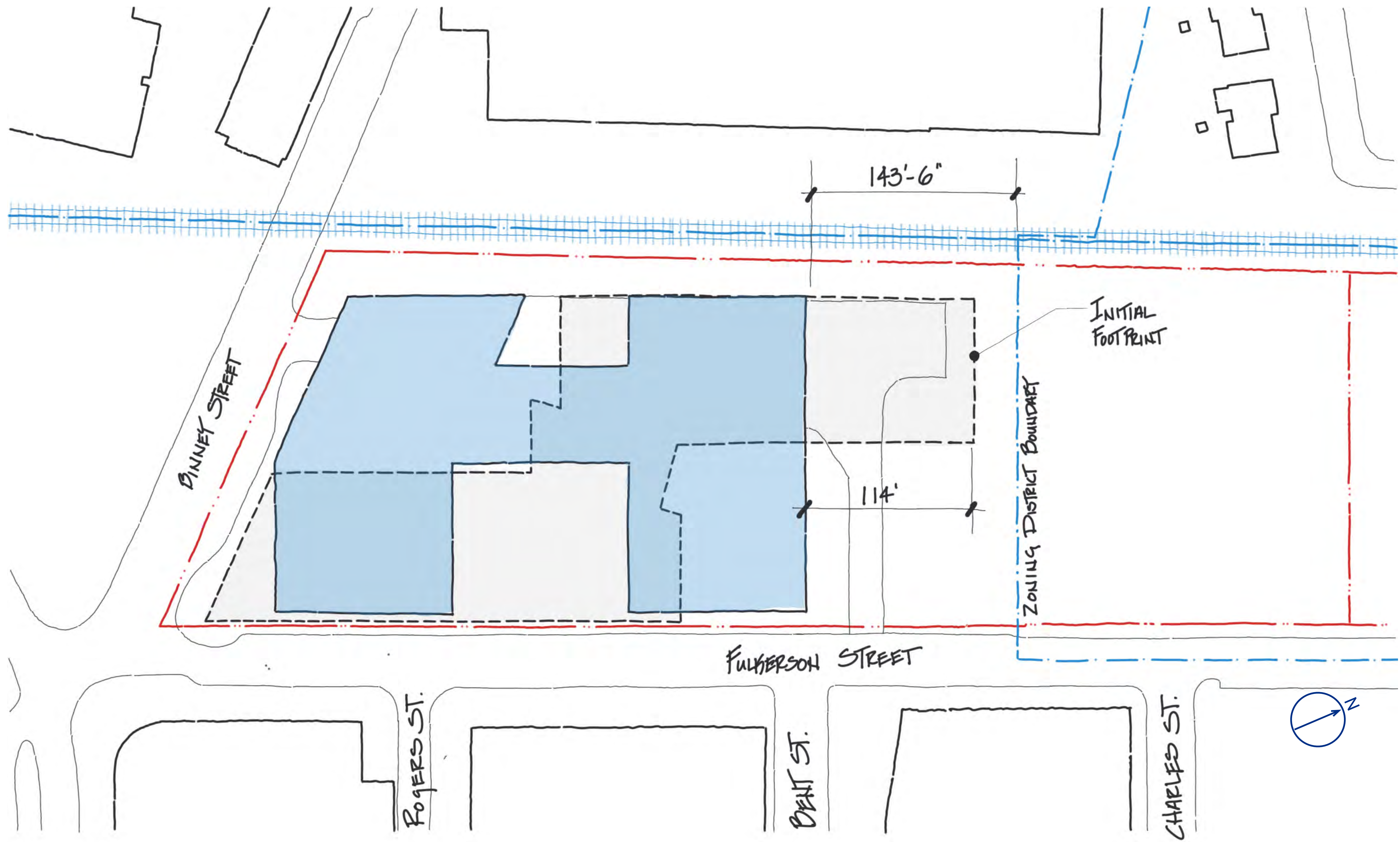





 Building Footprint

 Loading Area

 Planned Path, Construction to Begin 2019

 Proposed Grand Junction Path

 Unbuilt Area

 Driveway

 Cycle Track



ALEXANDRIA®

Building the Future of
Life-Changing Innovation™

Grand Junction Rail + Trail



SITE PLAN



A



B



C



EXISTING CONDITION

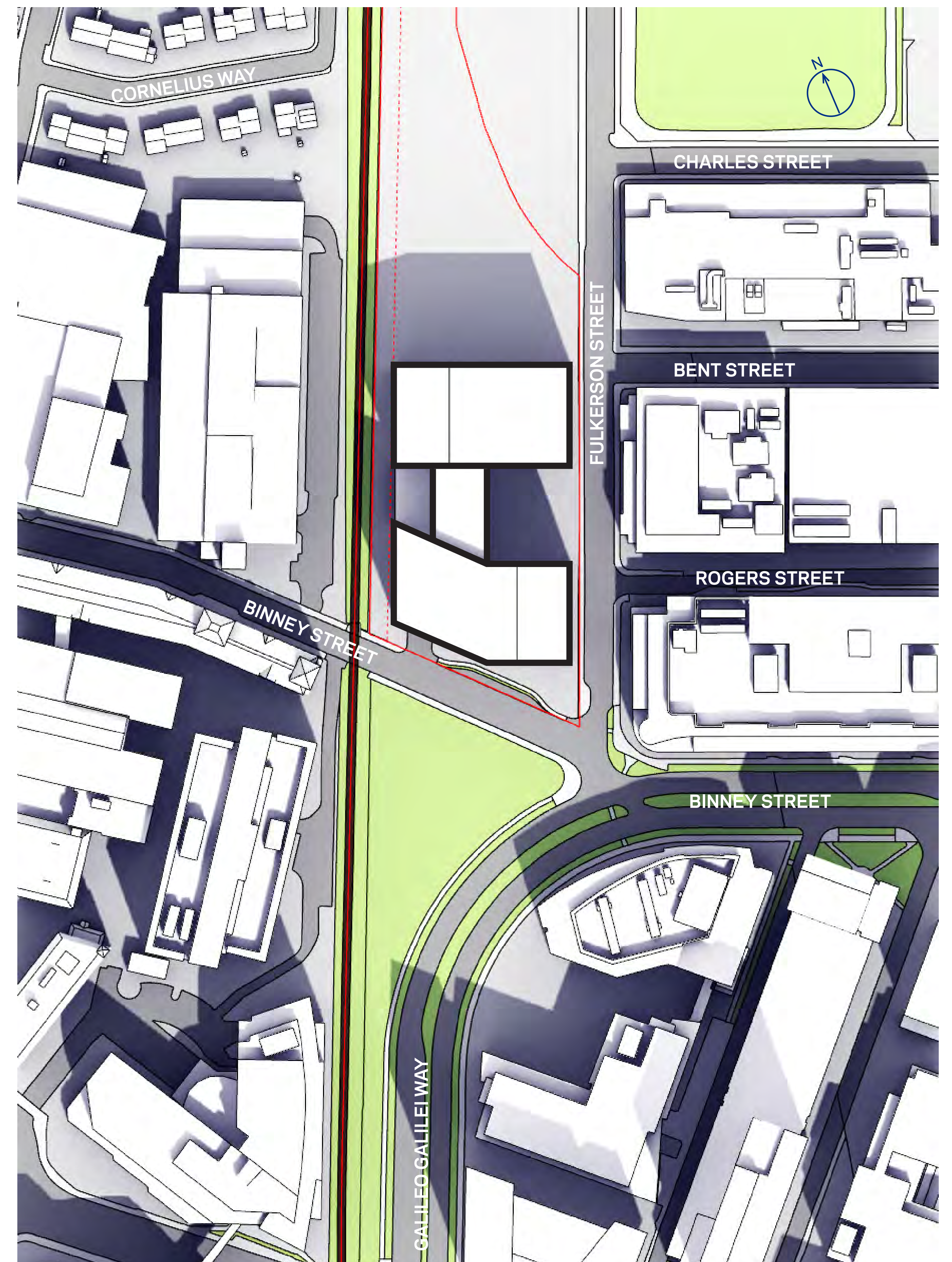

REVISED FOOTPRINT



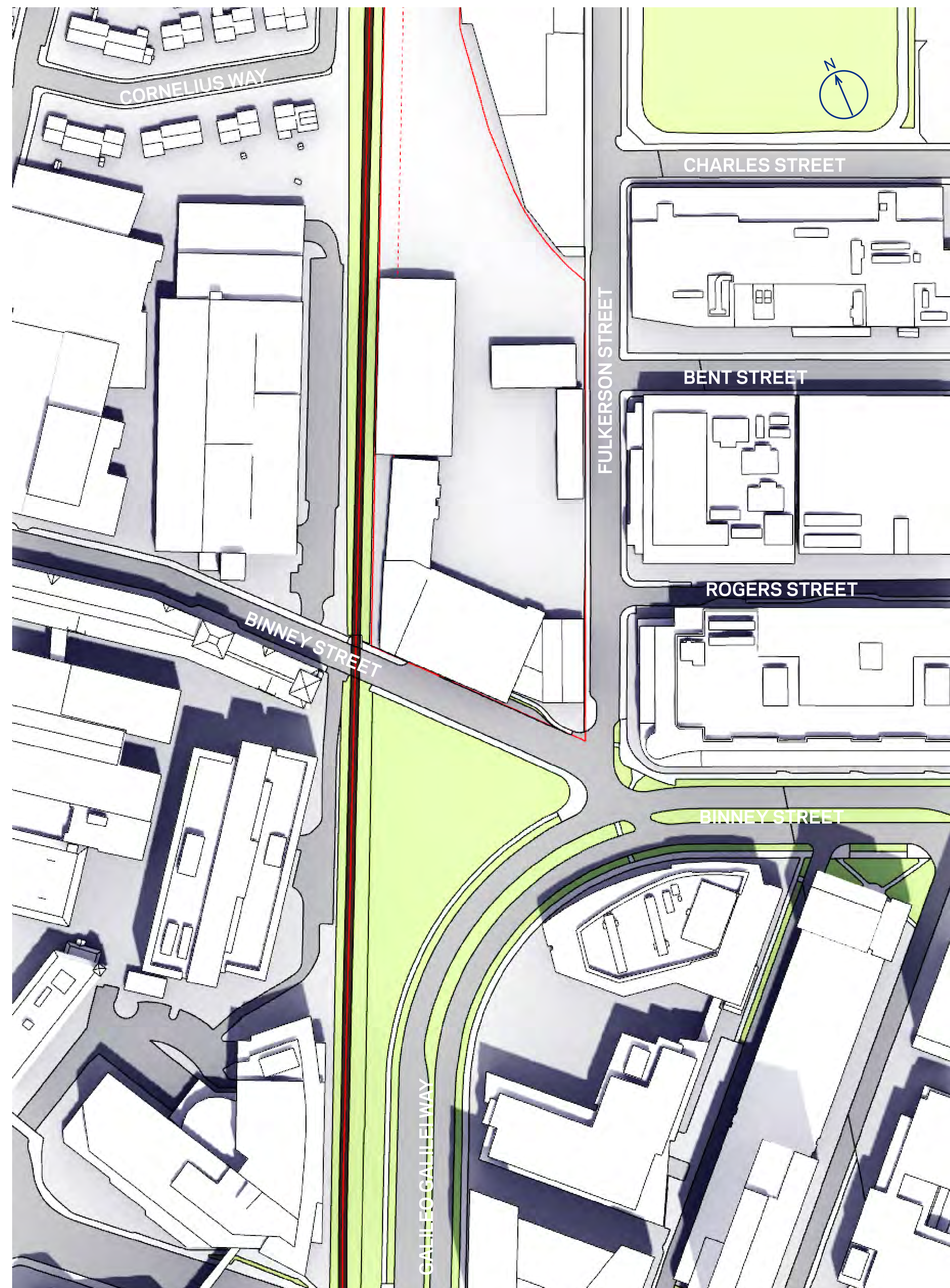

EXISTING CONDITION

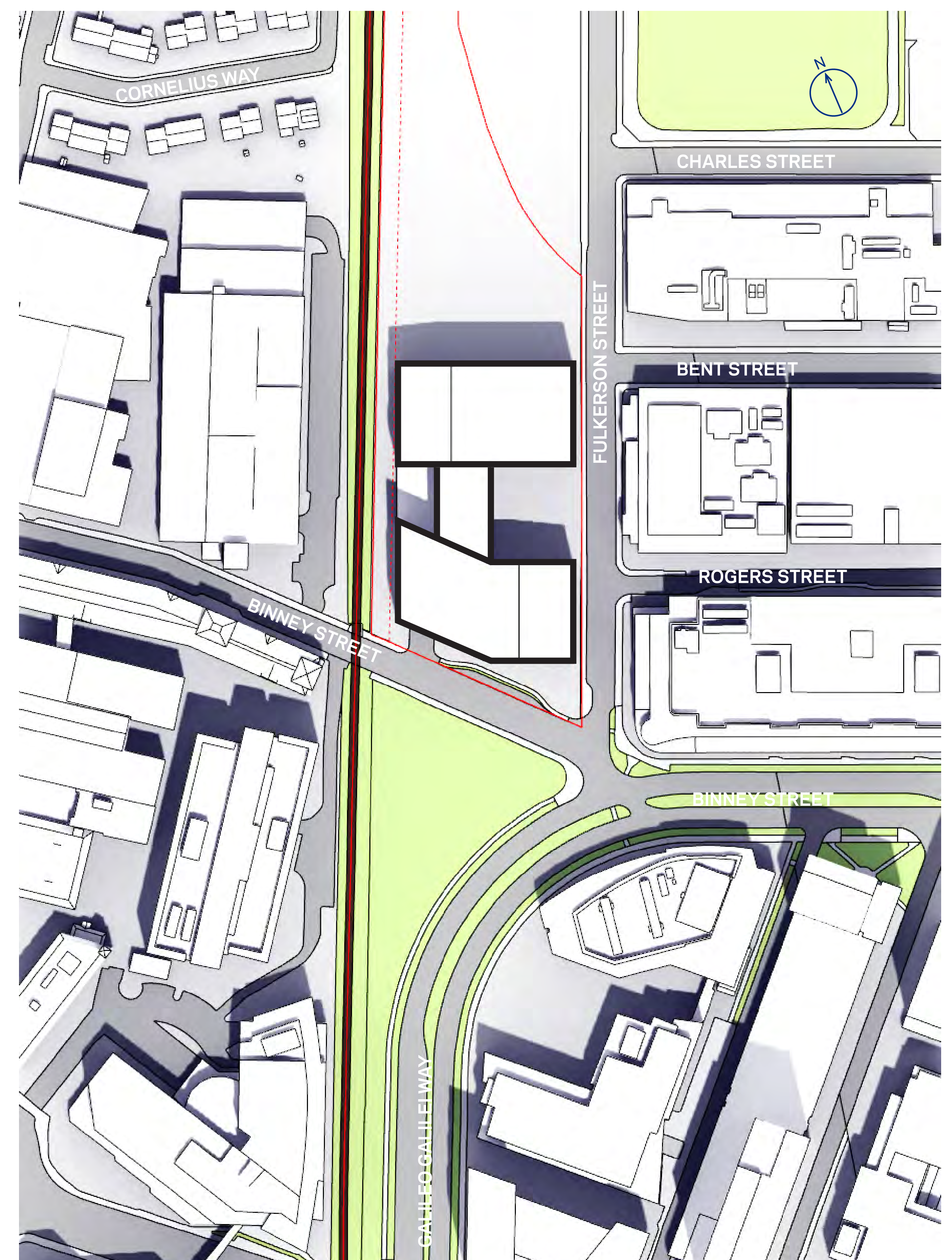

REVISED FOOTPRINT



EXISTING CONDITION

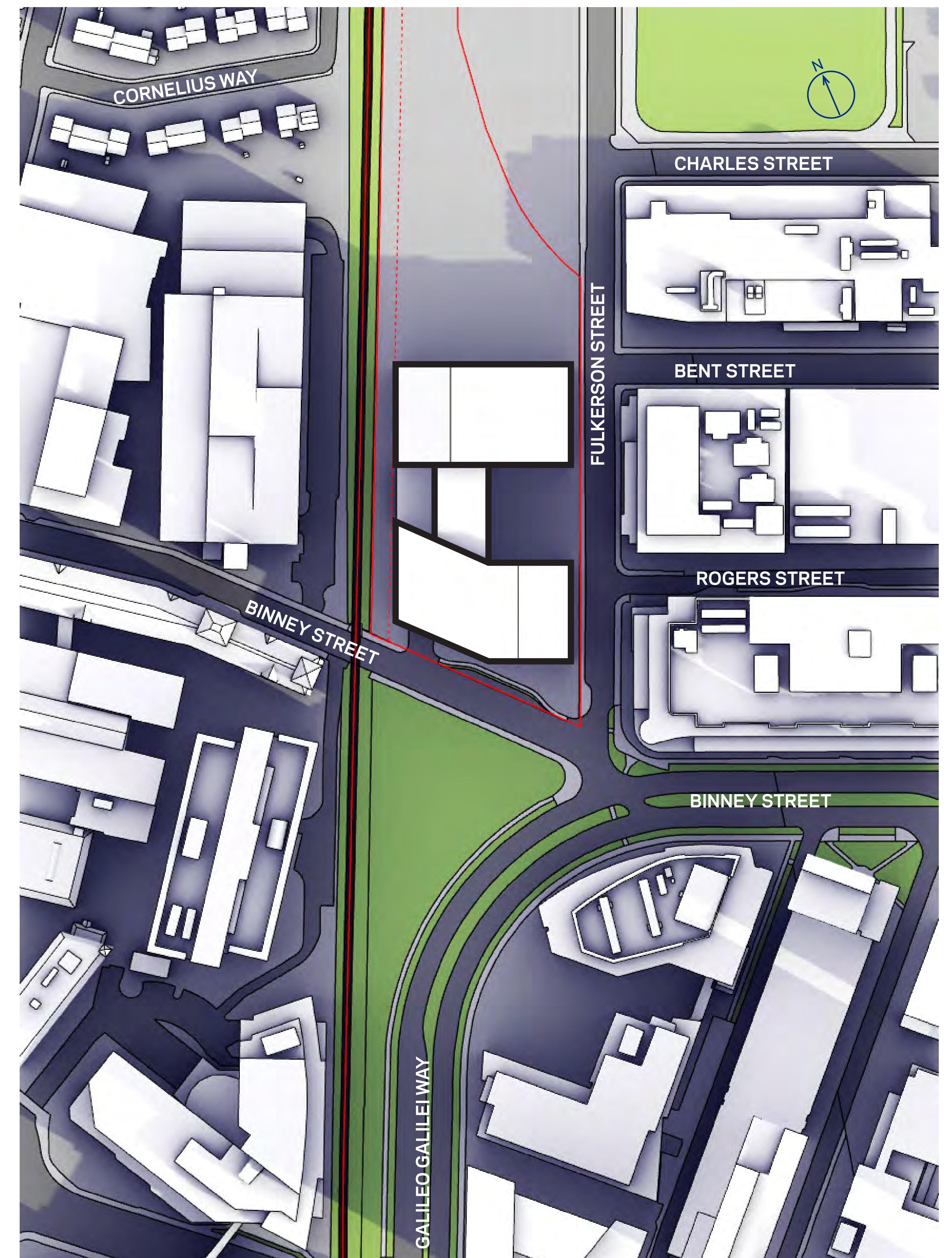

REVISED FOOTPRINT



EXISTING CONDITION

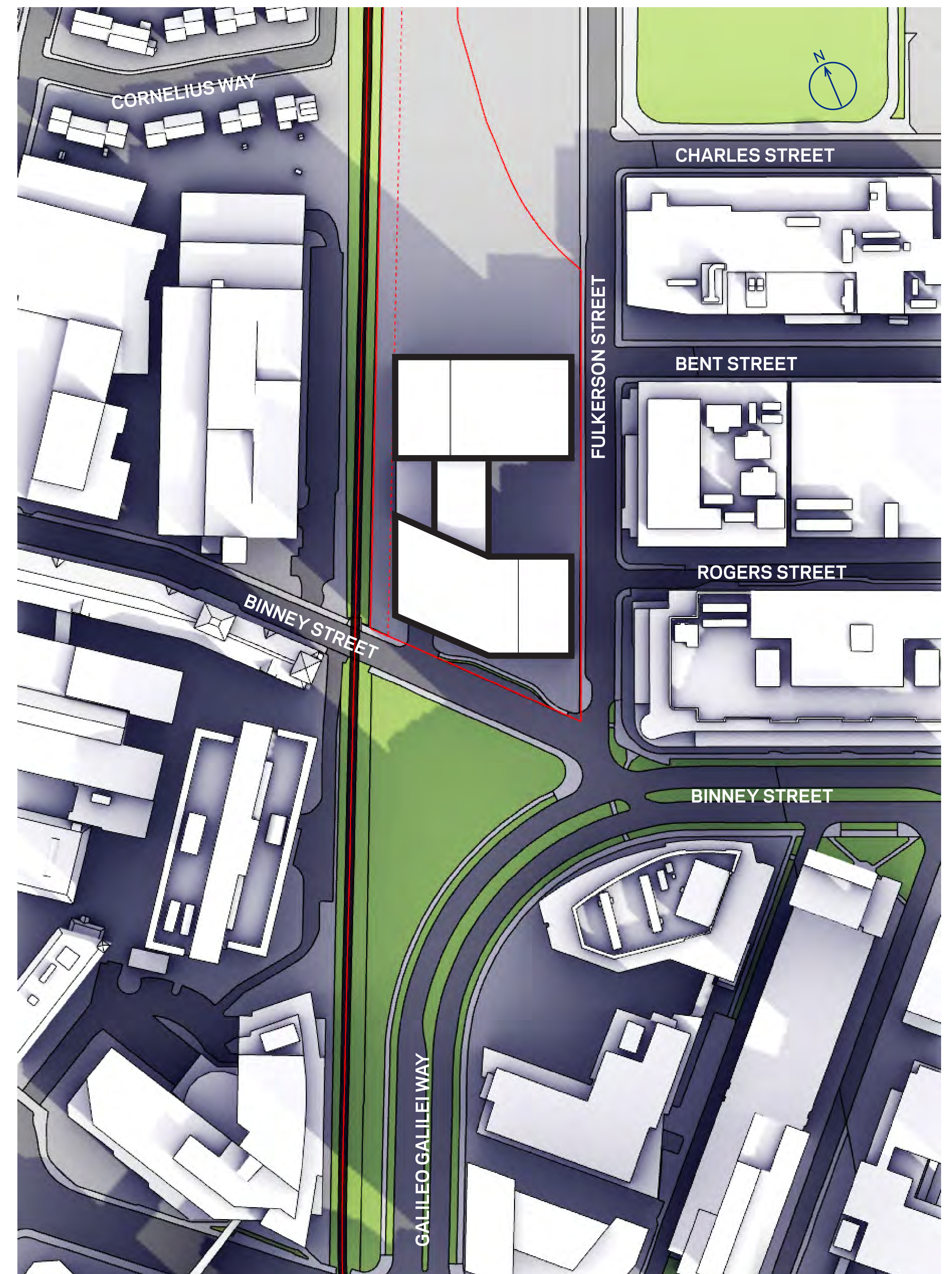

REVISED FOOTPRINT





EXISTING CONDITION



REVISED FOOTPRINT



EXISTING CONDITION

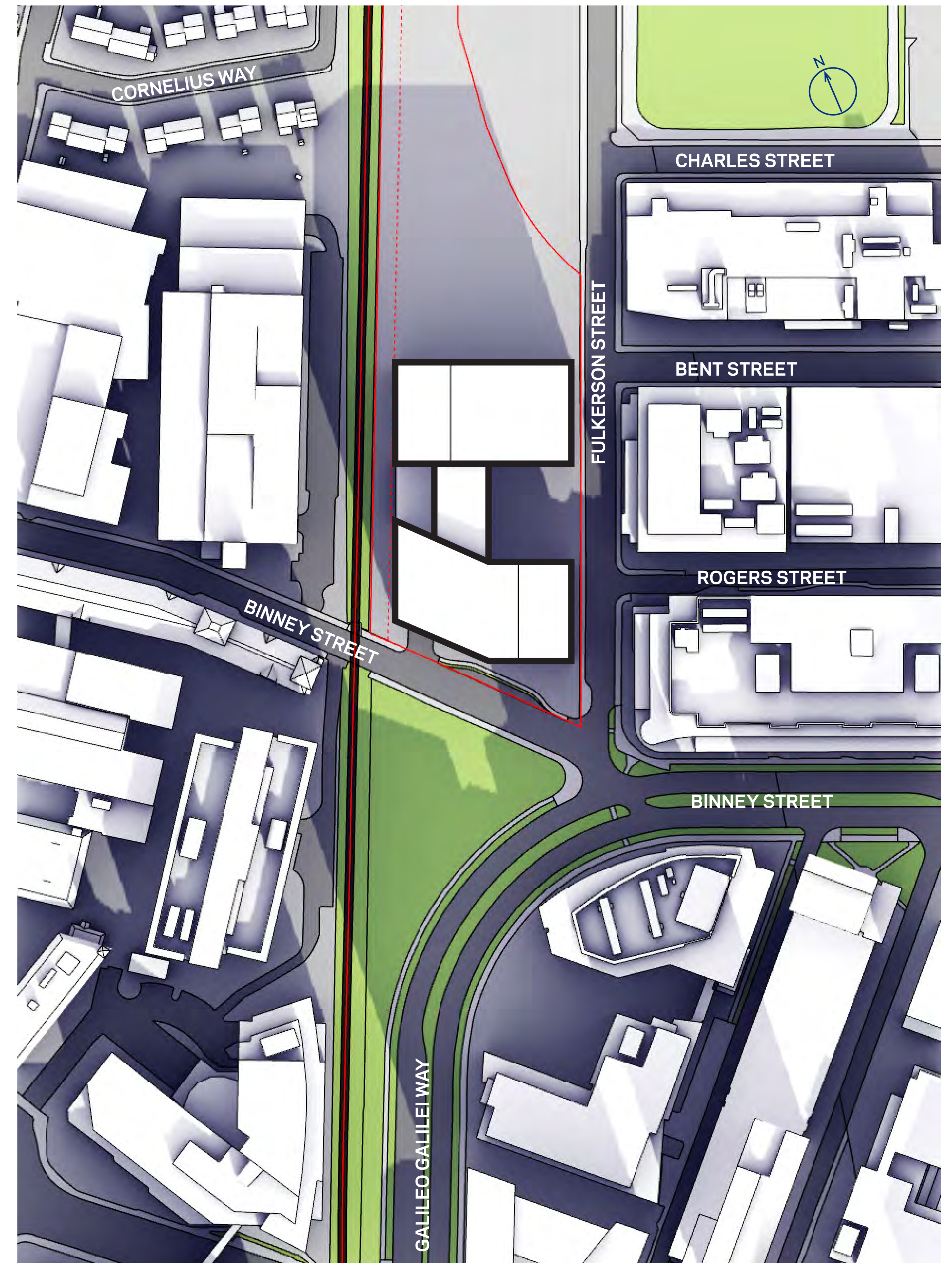

REVISED FOOTPRINT

